

DO NOT SCALE

100  
0  
10  
Millimetres

KEY:

CHAINAGE

KERB

EXISTING KERB

CARRIAGEWAY

SHARED USE FOOTWAY

VERGE

BUFFER

TRAFFIC ISLAND

TACTILE PAVING  
(CONTROLLED CROSSING - RED COLOUR)

ROAD MARKINGS

EXISTING SIGN

SIGN

BOLLARD

SIGNAL

LIGHTING COLUMN

EXISTING VRS

VRS

EARTHWORKS. SEE NOTES 5 & 6

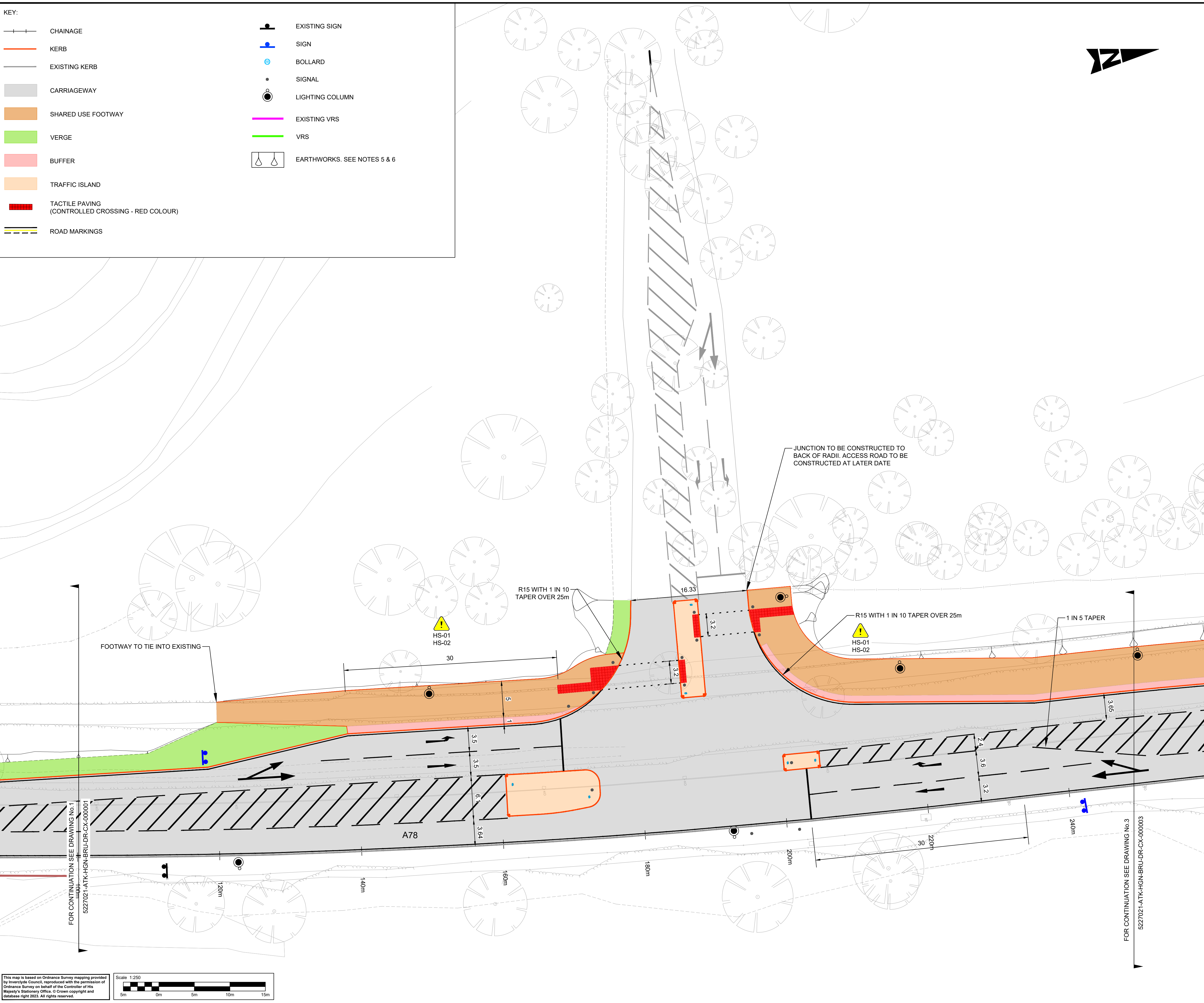

- NOTES:
- ALL DIMENSIONS ARE IN METRES UNLESS OTHERWISE STATED.
  - THIS DRAWING IS FOR REFERENCE ONLY AND SHOULD BE READ IN CONJUNCTION WITH ALL OTHER ENGINEERING DRAWINGS.
  - DO NOT SCALE FROM THIS DRAWING.
  - UTILITY INFORMATION HAS BEEN OMITTED FOR CLARITY. THE CONTRACTOR IS RESPONSIBLE FOR VERIFYING THE EXACT LOCATION AND EXTENT OF BURIED SERVICES PRIOR TO COMMENCEMENT OF WORKS. FOR INDICATIVE LOCATIONS OF UTILITIES REFER TO 52227201-ATK-UX-DRU-DR-CX-000001 TO 000003.
  - FOR STANDARD EARTHWORKS DETAILS REFER TO DRAWING 5227021-ATK-HGT-XX-DR-CE-000601 TO BE READ IN CONJUNCTION WITH 600 SERIES OF SPECIFICATIONS.
  - FOR GROUND INVESTIGATION DATA, REFER TO THE FACTUAL REPORT PREPARED BY DUNELM (2024) AND ASSOCIATED INTERPRETATIVE REPORT BY ATKINSREALIS (5227021-ATK-HGT-XX-RP-CE-000003)

SAFETY, HEALTH AND ENVIRONMENTAL INFORMATION

In addition to the hazards/risks normally associated with the types of work detailed on this drawing, note the following significant residual risks (Reference shall also be made to the design hazard log).

Construction  
HS-01 WORKS IN CLOSE PROXIMITY TO EXISTING SERVICES  
HS-02 NO PLAN AVAILABLE FOR UTILITY ASSETS ASSOCIATED WITH INVERCLYDE COUNCIL (CONTRACTOR TO CONFIRM LOCATION ON SITE PRIOR TO THE WORKS)

Maintenance / Cleaning  
HS-01 WORKS IN CLOSE PROXIMITY TO EXISTING SERVICES  
HS-02 NO PLAN AVAILABLE FOR UTILITY ASSETS ASSOCIATED WITH INVERCLYDE COUNCIL (CONTRACTOR TO CONFIRM LOCATION ON SITE PRIOR TO THE WORKS)

Use  
NONE

Decommissioning / Demolition  
HS-01 WORKS IN CLOSE PROXIMITY TO EXISTING SERVICES  
HS-02 NO PLAN AVAILABLE FOR UTILITY ASSETS ASSOCIATED WITH INVERCLYDE COUNCIL (CONTRACTOR TO CONFIRM LOCATION ON SITE PRIOR TO THE WORKS)

Status	Revision	Drawn	Checked	Reviewed	Authorised	Issue Date
Description						

Status	Revision	Drawn	Checked	Reviewed	Authorised	Issue Date
Description						

Status	Revision	Drawn	Checked	Reviewed	Authorised	Issue Date
S3	P01	CG	CC	AM	---	26/07/24

Status	Revision	Drawn	Checked	Reviewed	Authorised	Issue Date
S3	P02	KM	CC	AM	---	18/02/25

Status	Revision	Drawn	Checked	Reviewed	Authorised	Issue Date
A3	C01	MG	CC	AM	CS	20/02/25

Drawing Suitability	Status
APPROVED - CONSTRUCTION	A3

2 Atlantic Square  
Glasgow  
G2 8NJ  
Scotland

Tel: +44 (0)141 220 2000  
Fax: +44 (0)141 220 2001  
www.AtkinsRealis.com

Client

Project Title  
INVERKIP JUNCTION IMPROVEMENTS

Drawing Title  
A78 BRUEACRE  
GENERAL ARRANGEMENT  
SHEET 2 OF 3

Drawing Number	Project	Originator	Volume
5227021	- ATK	- HGN	-
BRU	- DR - CX - 000002	Type	Role
Location	Project Ref. No.	Sheet	Rev.
A1	5227021	1 of 1	C01

This map is based on Ordnance Survey mapping provided by Inverclyde Council, reproduced with the permission of Ordnance Survey on behalf of the Controller of His Majesty's Stationery Office. © Crown copyright and database right 2023. All rights reserved.

Scale 1:250

5m 0m 5m 10m 15m