

DO NOT SCALE

100
0 10
Millimetres

- KEY:
- CHAINAGE
 - KERB
 - EXISTING KERB
 - CARRIAGEWAY
 - FOOTWAY
 - VERGE
 - BUFFER
 - TRAFFIC ISLAND
 - TACTILE PAVING
(CONTROLLED CROSSING - RED COLOUR)
 - TRAM AND LADDER PAVING
(BUFF COLOUR)
 - BUS STOP FLAG
 - EXISTING SIGN
 - SIGN
 - BOLLARD
 - SIGNAL
 - LIGHTING COLUMN
 - ROAD MARKINGS
 - EXISTING VRS
 - VRS
 - BUS SHELTER

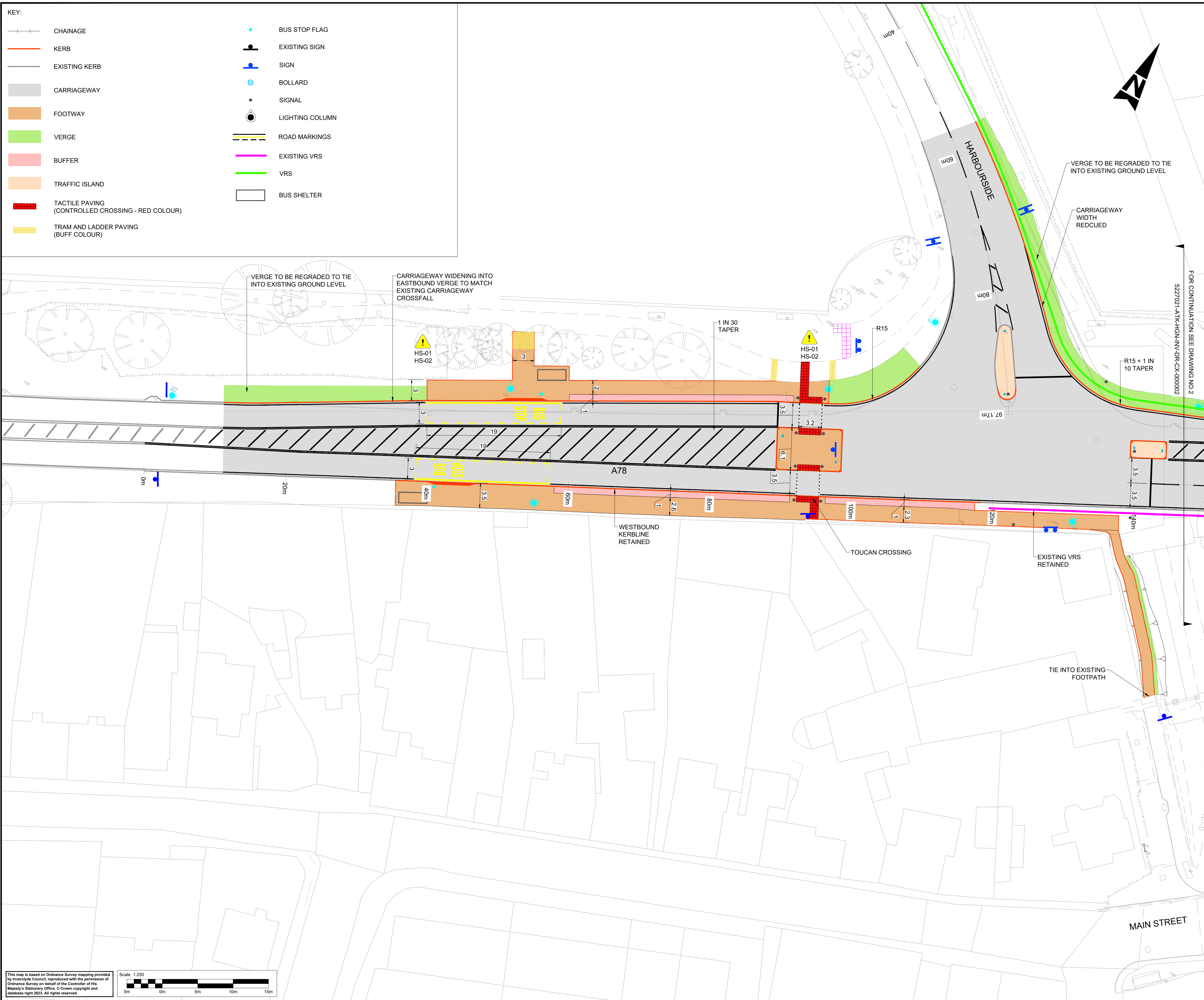

- NOTES:
- ALL DIMENSIONS ARE IN METRES UNLESS OTHERWISE STATED.
 - THIS DRAWING IS FOR REFERENCE ONLY AND SHOULD BE READ IN CONJUNCTION WITH ALL OTHER ENGINEERING DRAWINGS.
 - DO NOT SCALE FROM THIS DRAWING.
 - UTILITY INFORMATION HAS BEEN OMITTED FOR CLARITY. THE CONTRACTOR IS RESPONSIBLE FOR VERIFYING THE EXACT LOCATION AND EXTENT OF BURIED SERVICES PRIOR TO COMMENCEMENT OF WORKS. FOR INDICATIVE LOCATIONS OF UTILITIES REFER TO 5227201-ATK-UXX-INV-DR-CX-000001 TO 000004.
 - FOR STANDARD EARTHWORKS DETAILS REFER TO DRAWING 5227021-ATK-HGT-XX-DR-CE-000601 (TO BE READ IN CONJUNCTION WITH 600 SERIES OF SPECIFICATIONS).
 - FOR GROUND INVESTIGATION DATA, REFER TO THE FACTUAL REPORT PREPARED BY DUNELM (2024) AND ASSOCIATED INTERPRETATIVE REPORT BY ATKINSREALIS (5227021-ATK-HGT-XX-RP-CE-000003).

SAFETY, HEALTH AND ENVIRONMENTAL INFORMATION

In addition to the hazards/risks normally associated with the types of work detailed on this drawing, note the following significant residual risks (Reference shall also be made to the design hazard log).

Construction
HS-01 WORKS IN CLOSE PROXIMITY TO EXISTING SERVICES
HS-02 NO PLAN AVAILABLE FOR UTILITY ASSETS ASSOCIATED WITH INVERCLYDE COUNCIL (CONTRACTOR TO CONFIRM LOCATION ON SITE PRIOR TO THE WORKS)

Maintenance / Cleaning
HS-01 WORKS IN CLOSE PROXIMITY TO EXISTING SERVICES
HS-02 NO PLAN AVAILABLE FOR UTILITY ASSETS ASSOCIATED WITH INVERCLYDE COUNCIL (CONTRACTOR TO CONFIRM LOCATION ON SITE PRIOR TO THE WORKS)

Use
NONE

Decommissioning / Demolition
HS-01 WORKS IN CLOSE PROXIMITY TO EXISTING SERVICES
HS-02 NO PLAN AVAILABLE FOR UTILITY ASSETS ASSOCIATED WITH INVERCLYDE COUNCIL (CONTRACTOR TO CONFIRM LOCATION ON SITE PRIOR TO THE WORKS)

Description

Status	Revision	Drawn	Checked	Reviewed	Authorised	Issue Date
--------	----------	-------	---------	----------	------------	------------

Description

Status	Revision	Drawn	Checked	Reviewed	Authorised	Issue Date
--------	----------	-------	---------	----------	------------	------------

Description

Status	Revision	Drawn	Checked	Reviewed	Authorised	Issue Date
--------	----------	-------	---------	----------	------------	------------

Description

FOR CONSULTATION WITH STAKEHOLDERS

Status	Revision	Drawn	Checked	Reviewed	Authorised	Issue Date
S3	P01	CG	CC	AM	---	28/07/24

FOR CONSTRUCTION

Status	Revision	Drawn	Checked	Reviewed	Authorised	Issue Date
A3	C01	MG	CC	AM	CS	20/02/25

Drawing Suitability

APPROVED - CONSTRUCTION

A3

2 Atlantic Square
Glasgow
G2 8NJ
Scotland

Tel: +44 (0)141 220 2000
Fax: +44 (0)141 220 2001
www.AtkinsRealis.com

Copyright © AtkinsRéalis (2023)

Client

Inverclyde council

Balfour Beatty

SCAPE SCOTLAND
CIVIL ENGINEERING

Project Title

INVERKIP JUNCTION IMPROVEMENTS

Drawing Title

A78 MAIN STREET
GENERAL ARRANGEMENT
SHEET 1 OF 4

Drawing Number

Project

5227021 - ATK - HGN - INV - DR - CX - 000001

Location

Original Size: A1 Scale: 1:250 Project Ref. No: 5227021 Sheet: 1 of 4 Rev: C01

This map is based on Ordnance Survey mapping provided by Inverclyde Council, reproduced with the permission of Ordnance Survey on behalf of the Controller of His Majesty's Stationery Office. © Crown copyright and database right 2023. All rights reserved.

