Report To: THE INVERCLYDE COUNCIL

Date: 9 June 2011

Report By: CORPORATE DIRECTOR
REGENERATION AND
ENVIRONMENT

Report No: LA/698/11

Contact Officer: AUDREY WARMISHAM

Contact No: 01475 712118

Subject: PROPOSED TRAFFIC REGULATION ORDER – DISABLED
PERSONS' PARKING PLACES (ON STREET) ORDER NO 1 2011

1.0 PURPOSE

- 1.1 The purpose of the report is to introduce Traffic Regulation Order – Disabled Persons' Parking Places (On Street) Order No 1 2011.

2.0 BACKGROUND

- 2.1 In order to comply with the Traffic Signs Regulations and General Directions 2002, 7(1) and 7(2) and to provide assistance to disabled persons who hold a badge under the Disabled Persons (Badges for Motor Vehicles) (Scotland) Regulations 2000 as amended, the Safe, Sustainable Communities Committee at the meeting held on 3 May 2011 agreed that The Inverclyde Council be asked to make the Traffic Regulation Order – Disabled Persons' Parking Places (On Street) Order No 1 2011 in terms of the Road Traffic Regulation Act 1984 and Roads (Scotland) Act 1984 and associated Regulations.
- 2.2 The proposals have been advertised. One objection was received but was subsequently withdrawn.
- 2.3 There are no legal or financial implications.

3.0 RECOMMENDATION

- 3.1 That a Resolution is made in the following terms:
- 3.2 THE INVERCLYDE COUNCIL, incorporated under the Local Government etc. (Scotland) Act 1994, RESOLVE TO MAKE as they HEREBY MAKE a Resolution under Section 32(1) and Part III of Schedule 9 of the Road Traffic Regulation Act 1984 to permit the provision of parking places for disabled persons who hold a badge under the Disabled Persons (Badges for Motor Vehicles) (Scotland) Regulations 2000 as amended all as detailed in a copy of the Order forming a supplement to the principal minute hereof, and that the Head of Environmental & Commercial Services and Head of Legal & Democratic Services be authorised to take all necessary action in connection therewith.

Appendix

Legal & Democratic Services

THE INVERCLYDE COUNCIL

DISABLED PERSONS' PARKING PLACES
(ON STREET) ORDER NO 1 2011

TRAFFIC REGULATION ORDER

THE INVERCLYDE COUNCIL

DISABLED PERSONS' PARKING PLACES (ON STREET) ORDER NO 1 2011

The Inverclyde Council in exercise of the powers conferred on them by Sections 32(1) of the Road Traffic Regulation Act 1984 ("the Act") and of all other enabling powers and after consultation with the Chief Constable of Strathclyde Police in accordance with Part III of Schedule 9 to the Act hereby make the following Order.

1. This Order may be cited as "The Inverclyde Council Disabled Persons' Parking Places (On Street) Order No 1 2011 and shall come into operation on #####.
2. In this Order the following expressions have the meanings hereby assigned to them:
 - "vehicle" unless the context otherwise requires, means a vehicle of any description and includes a machine or implement of any kind drawn or propelled along roads whether or not by mechanical power;
 - "parking place" means a place where a vehicle, or vehicles of any class, may wait i.e. the area of land specified in the Schedule for which the use as a parking place has been authorised by the Council under Section 32(1) of the Act;
 - "sign" means a traffic sign;
 - "disabled person's badge" means:
 - (a) a badge issued under Section 21 of the Chronically Sick and Disabled Persons Act 1970;
 - (b) a badge issued under a provision of the law of Northern Ireland corresponding to that section; or
 - (c) a badge issued by any member State other than the United Kingdom for purposes corresponding to the purposes for which badges under that section are issued;
 - "disabled person's vehicle" means a vehicle lawfully displaying a disabled person's badge;
 - "Council" means The Inverclyde Council;
3. Each area of road which is described in the Schedule and plans relative to this Order is hereby designated as a parking place.
4. The parking places designated in this Order shall only be used for the leaving of disabled persons' vehicles displaying a valid disabled person's badge.

5. The limits of each parking place designated in this Order shall be indicated on the carriageway as prescribed by The Traffic Signs Regulations and General Directions 2002.
6. Every vehicle left in any parking place designated in this Order shall stand such that no parking place is occupied by more than one vehicle and that every part of the vehicle is within the limits of the parking place provided that, where the length of a vehicle precludes compliance with this paragraph, such vehicle shall be deemed to be within the limits of a parking place if;
 - i. the extreme front portion or, as the case may be, the extreme rear portion of the vehicle is within 300 mm of an indication on the carriageway provided under this Order in relation to the parking place; and
 - ii. the vehicle, or any part thereof, is not within the limits of any adjoining parking place.
7. Any person duly authorised by the Council or a police officer in uniform or a traffic warden or parking attendant may move or cause to be moved in case of any emergency, to any place they think fit, vehicles left in a parking place.
8. Any person duly authorised by the Council may suspend the use of a parking place or any part thereof whenever such suspension is considered reasonably necessary:
 - i. for the purpose of facilitating the movement of traffic or promoting its safety;
 - ii. for the purpose of any building operation, demolition, or excavation in or adjacent to the parking place or the laying, erection, alteration, removal or repair in or adjacent to the parking place of any sewer or of any main, pipe, apparatus for the supply of gas, water electricity or of any telecommunications apparatus, traffic sign or parking meter;
 - iii. for the convenience of occupiers of premises adjacent to the parking place on any occasion of the removal of furniture from one office or dwellinghouse to another or the removal of furniture from such premises to a depository or to such premises from a depository;
 - iv. on any occasion on which it is likely by reason of some special attraction that any street will be thronged or obstructed; or
 - v. for the convenience of occupiers of premises adjacent to the parking place at times of weddings or funerals or on other special occasions.
9. A police officer in uniform may suspend for not longer than twenty four hours the use of a parking place or part thereof whenever such suspension is considered reasonably necessary for the purpose of facilitating the movement of traffic or promoting its safety.

10. This Order insofar as it relates to the parking places to be revoked (R), as specified in the Schedule to this Order, partially revokes The Inverclyde Council On-Street Parking Places (Without Charges) Orders Nos 1 1999, 1 2000, 1 2002, 1 2004, 2 2005, 1 2006, 2 2006, 3 2007, 3 2009 and Disabled Persons' Parking Places (On Street) Order No 2 2010,

Sealed with the Common Seal of The Inverclyde Council and subscribed for them on their behalf by

DRAFT

INVERCLYDE COUNCIL

**DISABLED PERSONS' PARKING PLACES (ON STREET)
ORDER NO 1 2011**

**Statement of Reasons for Proposing to Make
the Above Order**

It is considered necessary to make the above Order to provide assistance for disabled persons who hold a badge under the Disabled Persons (Badges for Motor Vehicles) (Scotland) Regulations 2000 as amended and by revoking those parking places no longer required to maximise street parking capacity.

INVERCLYDE COUNCIL

DISABLED PERSONS' PARKING PLACES (ON-STREET) ORDER No. 1 2011

SCHEDULE

All and whole that area of ground as described in Column 2 in the table below:

<u>Ref No.</u>	<u>Address of Disabled Person's Parking Place to be created or revoked ® "ex-adverso"</u>
1034	7C Shaw Place, Greenock
1037	36 Finlaystone Road, Kilmacolm
1038	199 Grieve Road, Greenock
1039	14 Waverley Street, Greenock
1040	7 Shaw Place, Greenock
1042	22 Mavis Road, Greenock
1043	6 Dunlop Street, Greenock
1046	12 East Shaw Street, Greenock
1047	40 Quarry Drive, Kilmacolm
1049	48 Maple Road, Greenock
1050	27 Patrick Street, Greenock
1051	114 Forsyth Street, Greenock
1054	123 Finnart Street, Greenock
1055	37 Grant Street, Greenock

INVERCLYDE COUNCIL

DISABLED PERSONS' PARKING PLACES (ON-STREET) ORDER No. 1 2011

SCHEDULE

<u>Ref No.</u>	<u>Address of Disabled Person's Parking Place to be created or revoked ® "ex-adverso"</u>
9905	115 Bardrainey Avenue, Port Glasgow ®
9906	3 Cardross Crescent, Greenock ®
9914	37 Nelson Street, Greenock ®
9921	21 Devon Road, Greenock ®
0515	85 Albert Road, Gourock ®
0632	41 Ashton Road, Gourock ®
0726	33 Glenhuntly Terrace, Port Glasgow ®
0902	6 Nelson Road, Greenock ®
0982	22 Mearns Street, Greenock ®

council

ENVIRONMENTAL & COMMERCIAL SERVICES



28.5m

TRAFALGAR STREET

1040 1034
SHAW PLACE

MEARNS STREET

Nursery

3 Club

HEAD OF SERVICE
ALAN G BARNES MCIWM CENV

Disabled Bays

71 EAST HAMILTON STREET
GREENOCK, PA15 2UA

Reproduced from Ordnance Survey mapping with the permission of the Controller of Her Majesty's Stationery Office. Crown Copyright. Unauthorised reproduction infringes Crown Copyright and may result in prosecution or legal proceedings.

Licence No. LA03097L

Ordnance Survey

DISABLED PERSONS' PARKING PLACE

7 SHAW PLACE, GREENOCK
PLACE Nos. 1034 & 1040

Scale : 1:500	Date : NOV 2010
---------------	-----------------

Prepared by : R. MACKAY	Checked by :
-------------------------	--------------

Drawn by :	R. MACKAY	Approved by :	
------------	-----------	---------------	--

Drawing No. :	File No. : 19/12
---------------	------------------



HEAD OF SERVICE
ALAN G BARNES MCWM CENV

Disabled Bays

71 EAST HAMILTON STREET
GREENOCK, PA15 2UA

Reproduced from: Ordnance Survey mapping with the permission
of the Controller of Her Majesty's Stationery Office. Crown
Copyright. Unauthorised reproduction infringes Crown Copyright
and may result in prosecution or legal proceedings.

Licence No. LA03097L



DISABLED PERSONS' PARKING PLACE

36 FINLAYSTONE ROAD, KILMACOLM

PLACE No. 1037

Scale : 1:500

Prepared by : R. MACKAY

Drawn by : R. MACKAY

Drawing No. :

Date : NOV 2010

Checked by :

Approved by :

File No. : 19/12

Inverclyde council

ENVIRONMENTAL & COMMERCIAL SERVICES

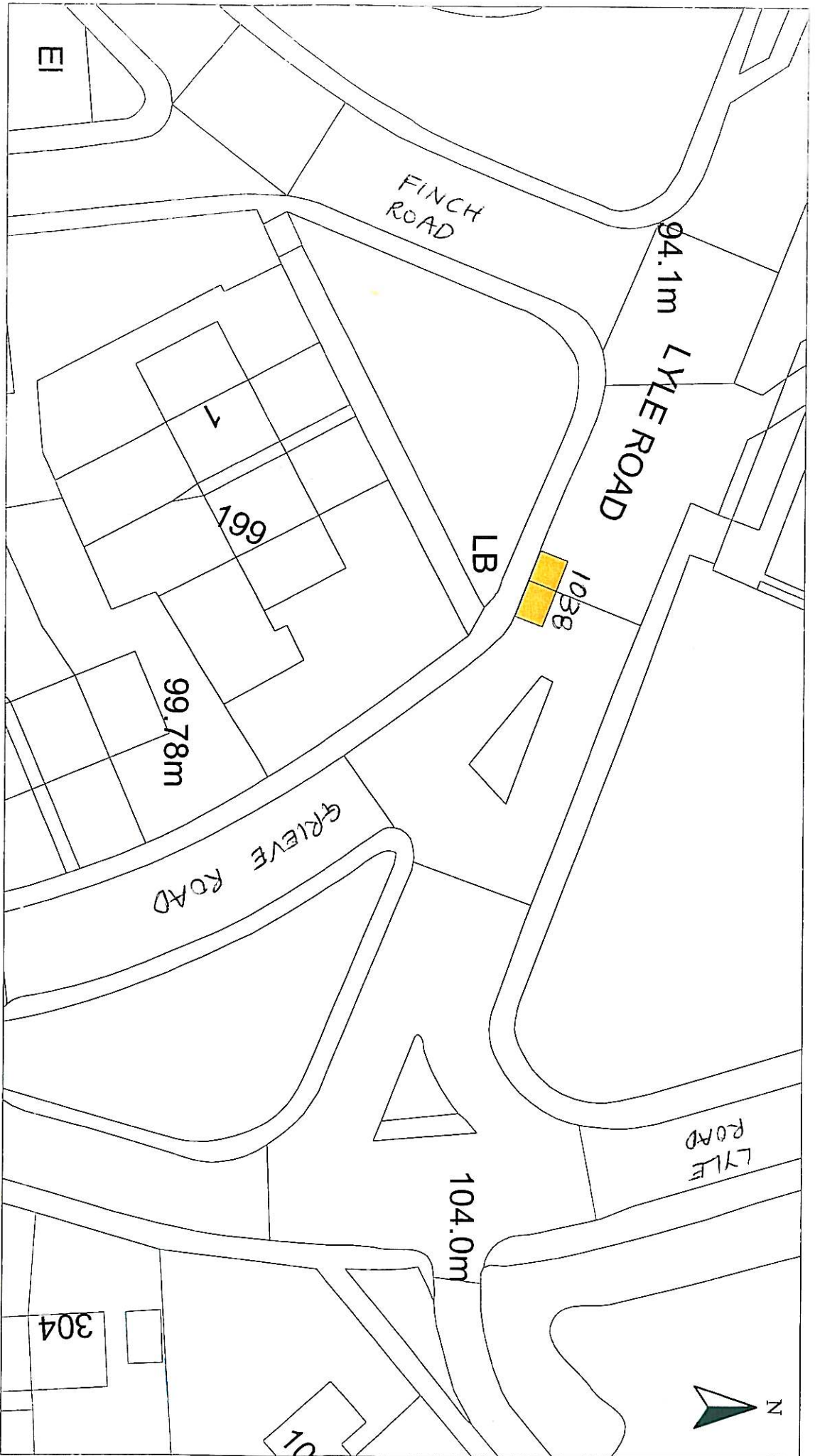

HEAD OF SERVICE ALAN G BARNES MCIVM CENV		DISABLED PERSONS' PARKING PLACE 199 GRIEVE ROAD, GREENOCK PLACE No. 1038			
Disabled Bays	71 EAST HAMILTON STREET GREENOCK, PA15 2UA	Reproduced from Ordnance Survey mapping with the permission of the Controller of Her Majesty's Stationary Office. Crown Copyright. Unauthorised reproduction infringes Crown Copyright and may result in prosecution or legal proceedings.			
		Licence No. LA03097L			
		 Ordnance Survey			
		Scale :	1:500	Date :	NOV 2010
		Prepared by :	R. MACKAY	Checked by :	
		Drawn by :	R. MACKAY	Approved by :	
		Drawing No. :		File No. :	19/12

Inverclyde council

ENVIRONMENTAL & COMMERCIAL SERVICES



HEAD OF SERVICE ALAN G BARNES MCIVM CENV		Disabled Bays	
71 EAST HAMILTON STREET GREENOCK, PA15 2UA		14 WAVERLEY STREET, GREENOCK PLACE No. 1039	
Reproduced from Ordnance Survey mapping with the permission of the Controller of Her Majesty's Stationery Office. Crown Copyright. All rights reserved. No part of this publication may be reproduced in any form or by any means, electronic or mechanical, including photocopying and recording, or by any information storage or retrieval system, without prior permission in writing from the Controller.		Licence No. LA03097L  Ordnance Survey	
Scale :	1:500	Date :	NOV 2010
Prepared by :	R. MACKAY	Checked by :	
Drawn by :	R. MACKAY	Approved by :	
Drawing No. :		File No. :	19/12

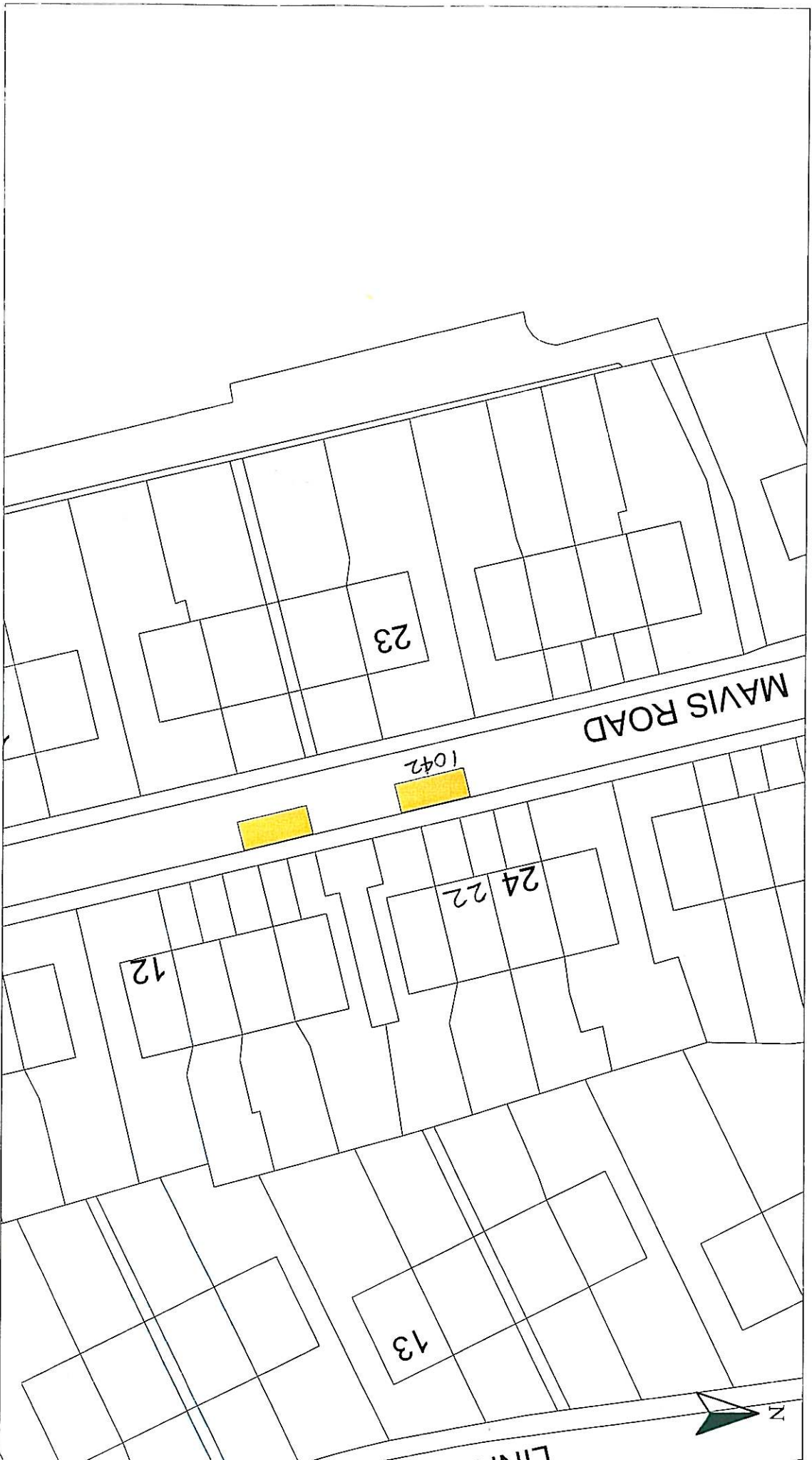

HEAD OF SERVICE
ALAN G BARNES MCWM CENV

Disabled Bays

71 EAST HAMILTON STREET
GREENOCK, PA15 2UA

Reproduced from Ordnance Survey mapping with the permission
of the Controller of Her Majesty's Stationery Office. Crown
Copyright. Unauthorised reproduction infringes Crown Copyright
and may result in prosecution or legal proceedings.

Licence No. LA03097L



DISABLED PERSONS' PARKING PLACE

22 MAVIS ROAD, GREENOCK
PLACE No. 1042

Scale : 1:500

Date : NOV 2010

Prepared by : R. MACKAY

Checked by :

Drawn by : R. MACKAY

Approved by :

Drawing No. :

File No. : 19/12

Inverclyde council

ENVIRONMENTAL & COMMERCIAL SERVICES



HEAD OF SERVICE ALAN G BARNES MCIVM CENV		Reproduced from Ordnance Survey mapping with the permission of the Controller of Her Majesty's Stationary Office. Crown Copyright. Unauthorised reproduction infringes Crown Copyright and may result in prosecution or legal proceedings.		DISABLED PERSONS' PARKING PLACE 6 DUNLOP STREET, GREENOCK PLACE No. 1043		
Disabled Bays	71 EAST HAMILTON STREET GREENOCK, PA15 2UA	Licence No. LA03097L  Ordnance Survey	Scale :	1:500	Date :	NOV 2010
			Prepared by :	R. MACKAY	Checked by :	
			Drawn by :	R. MACKAY	Approved by :	
			Drawing No. :		File No. :	19/12

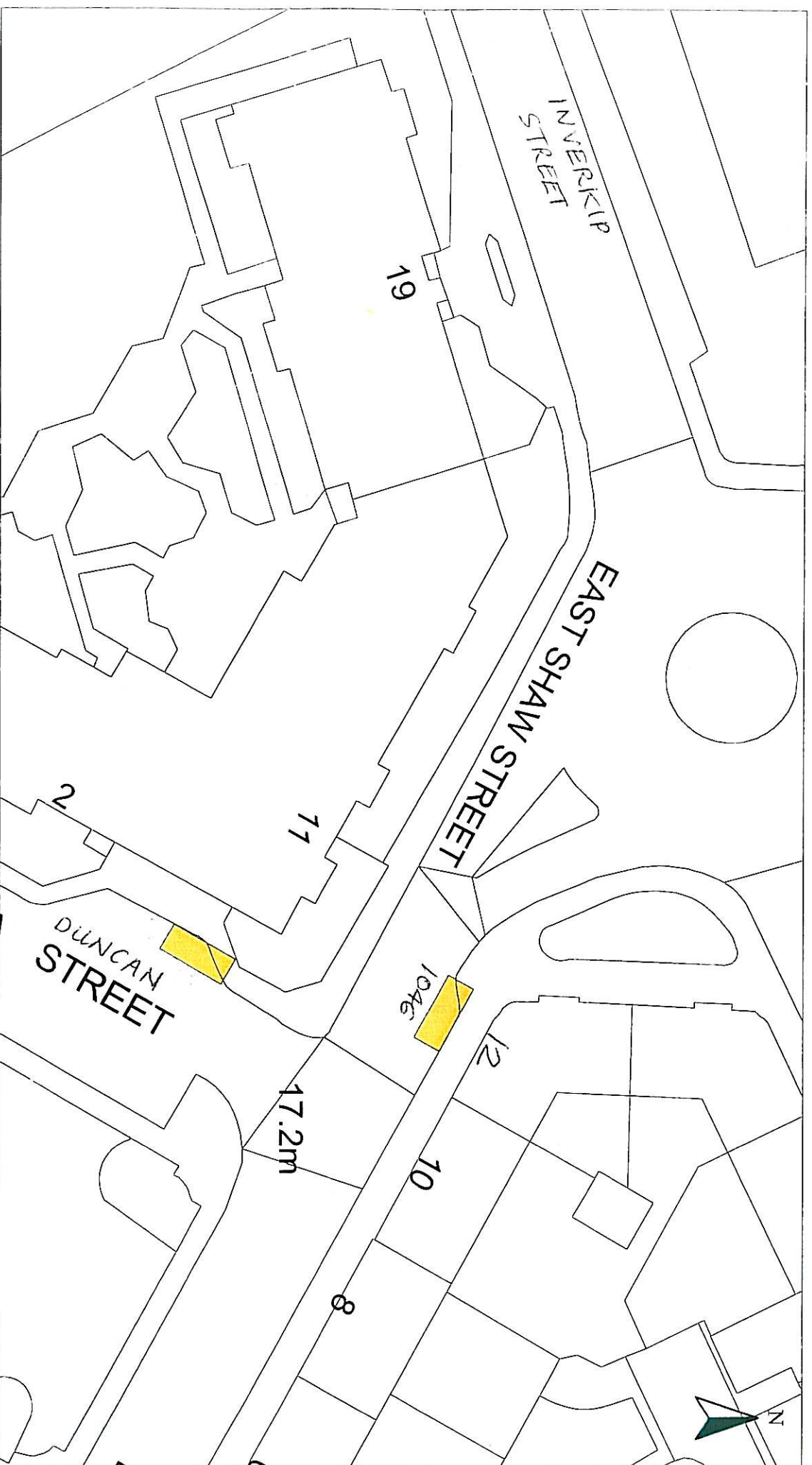

HEAD OF SERVICE ALAN G BARNES MCIMM CENV		<small>Reproduced from Ordnance Survey mapping with the permission of the Controller of Her Majesty's Stationery Office. Copyright. Unauthorised reproduction infringes Crown Copyright and may result in prosecution or legal proceedings.</small> Licence No. LA03097L  Ordnance Survey	DISABLED PERSONS' PARKING PLACE 12 EAST SHAW STREET, GREENOCK PLACE No. 1046	Scale : 1:500	Date : NOV 2010
Disabled Bays	71 EAST HAMILTON STREET GREENOCK, PA15 2UA			Prepared by : R. MACKAY	Checked by :
				Drawn by : R. MACKAY	Approved by :
				Drawing No. :	File No. : 19/12

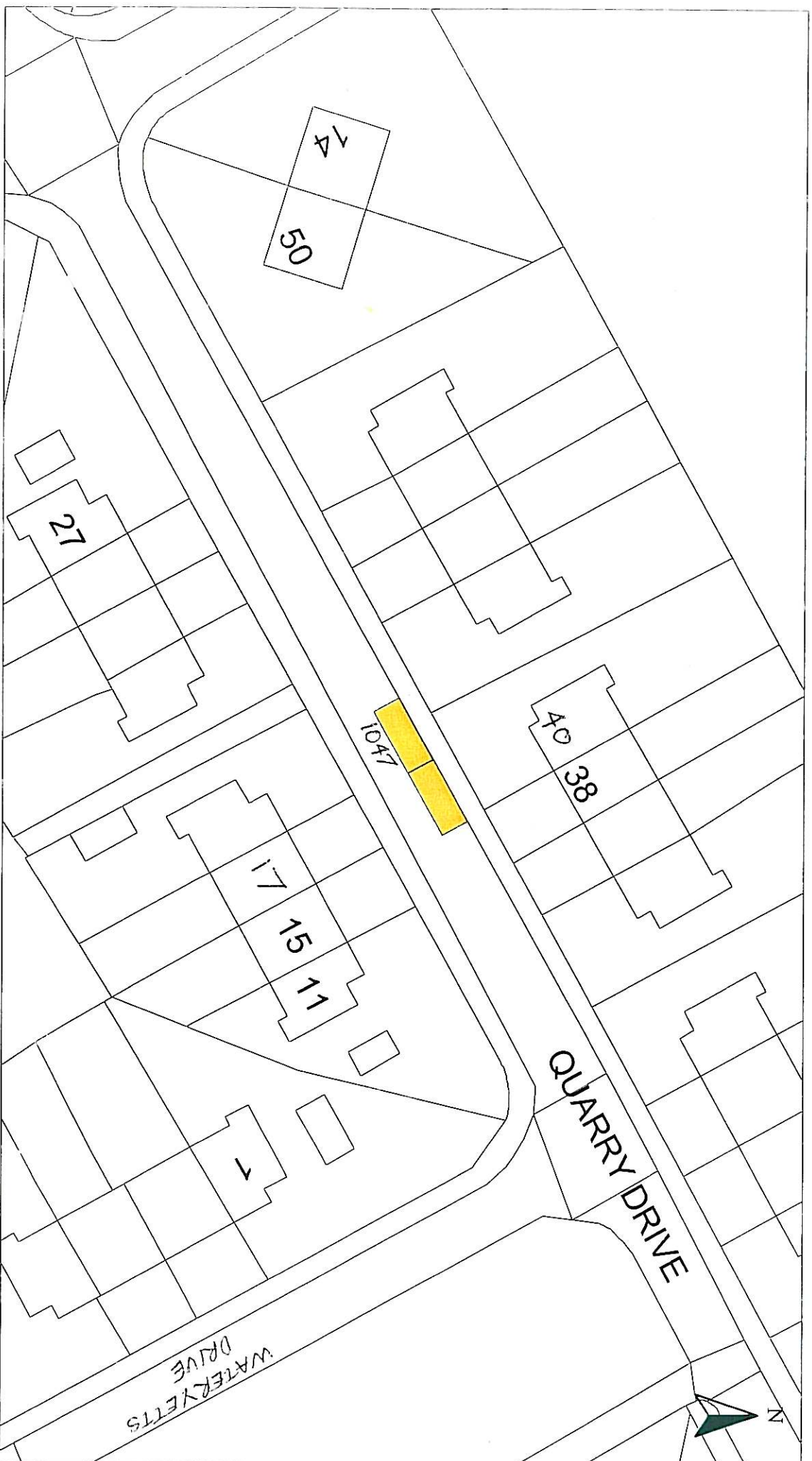

HEAD OF SERVICE ALAN G BARNES MCIMM CENV		Disabled Bays 71 EAST HAMILTON STREET GREENOCK, PA15 2UA	
Disabled Persons' Parking Place 40 QUARRY DRIVE, KILMACOLM PLACE No. 1047		Scale : 1:500 Prepared by : R. MACKAY Drawn by : R. MACKAY Drawing No. :	
Date : NOV 2010 Checked by : Approved by : File No. : 19/12		Permitted from Ordnance Survey mapping with the permission of the Ordnance Survey. No part of this publication may be reproduced, stored in a retrieval system, or transmitted, in any form or by any means, electronic, mechanical, photocopying, recording, or by any information storage or retrieval system, without prior written permission from the Ordnance Survey. Unauthorised reproduction infringes Crown Copyright and may result in prosecution or legal proceedings. Licence No. LA03097L  Ordnance Survey	

Inverclyde council

ENVIRONMENTAL & COMMERCIAL SERVICES



HEAD OF SERVICE ALAN G BARNES MCIMM CENV		Disabled Bays	
71 EAST HAMILTON STREET GREENOCK, PA16 2UA		Licence No. LA03097L	
Standardised from: Ordnance Survey mapping with the permission of the Controller of Her Majesty's Stationery Office. Crown Copyright. All rights reserved. No part of this publication may be reproduced in any form or by any means, electronic or mechanical, including photocopying and recording, or by any information storage or retrieval system, without prior permission in writing from the Controller of Her Majesty's Stationery Office.		Ordnance Survey	
DISABLED PERSONS' PARKING PLACE 46 MAPLE ROAD, GREENOCK PLACE No. 1049			
Scale :	1:500	Date :	NOV 2010
Prepared by :	R. MACKAY	Checked by :	
Drawn by :	R. MACKAY	Approved by :	
Drawing No. :		File No. :	19/12

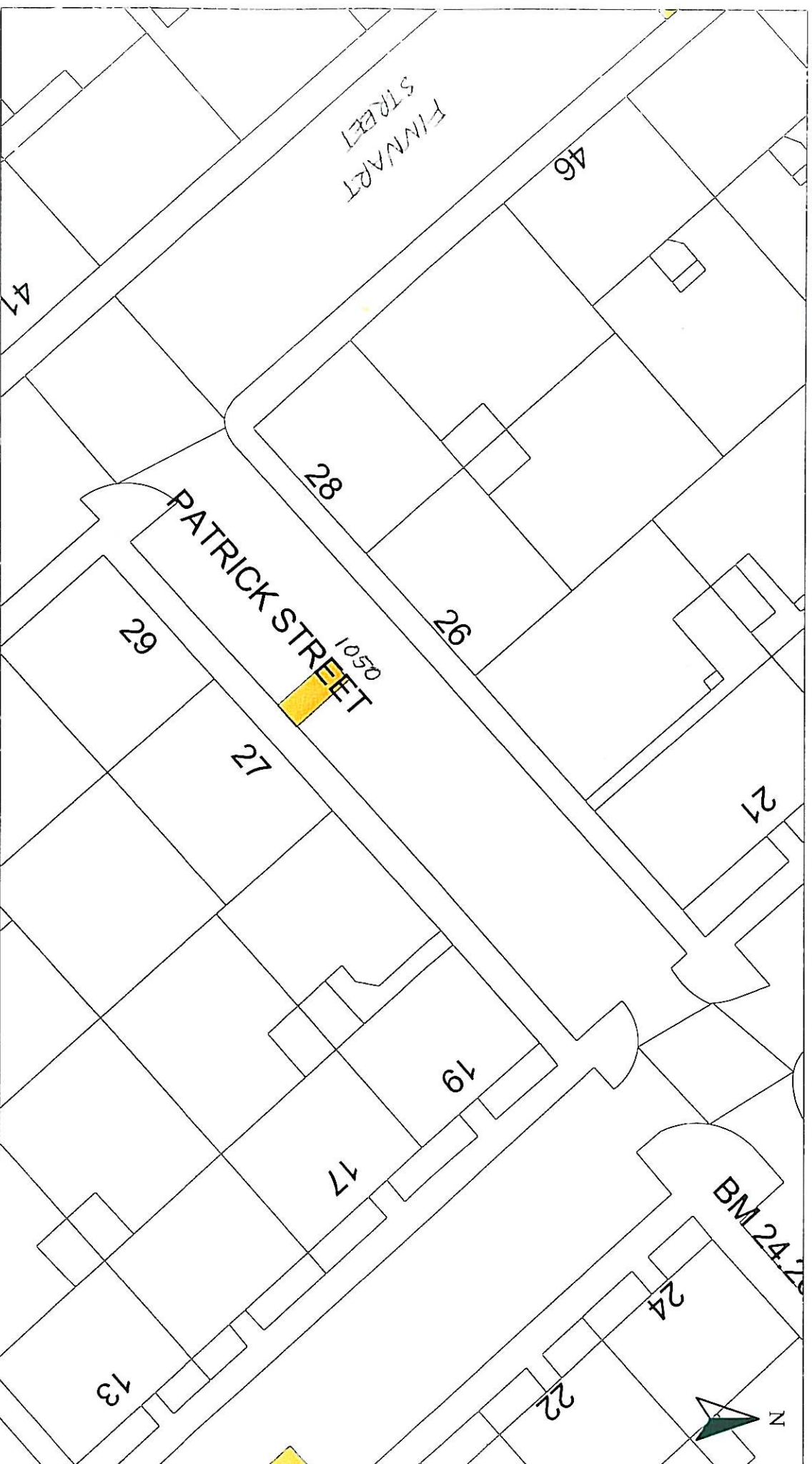

HEAD OF SERVICE ALAN G BARNES MCIMM CENV		<small>Reproduced from Ordnance Survey mapping with the permission of the Controller of Her Majesty's Stationery Office. Crown Copyright. Unauthorised reproduction infringes Crown Copyright and may result in prosecution or legal proceedings.</small>  Licence No. LA03097L	
Disabled Bays		71 EAST HAMILTON STREET GREENOCK, PA15 2UA	
DISABLED PERSONS' PARKING PLACE 27 PATRICK STREET, GREENOCK PLACE No 1050			
Scale :	1:500	Date :	NOV 2010
Prepared by :	R. MACKAY	Checked by :	
Drawn by :	R. MACKAY	Approved by :	
Drawing No. :		File No. :	19/12

Inverclyde council

ENVIRONMENTAL & COMMERCIAL SERVICES

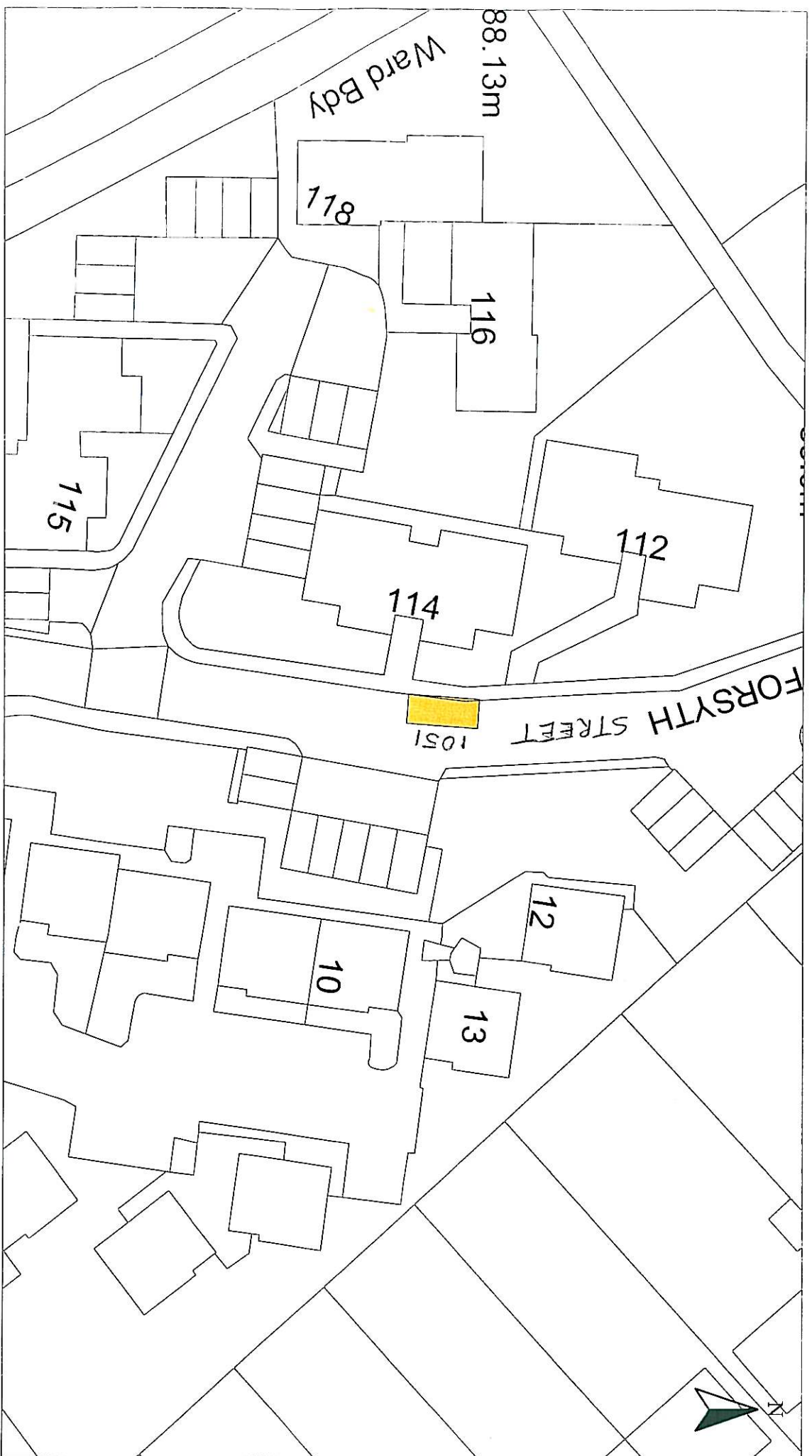

<p>HEAD OF SERVICE ALAN G BARNES MCIMM CENV</p> <p>71 EAST HAMILTON STREET GREENOCK, PA15 2UA</p>	<p>Re-produced from Ordnance Survey mapping with the permission of the Controller of Her Majesty's Stationery Office. Crown Copyright and may result in prosecution or legal proceedings.</p> <p>Licence No. LA03097L</p> <p> Ordnance Survey</p>	<p>DISABLED PERSONS' PARKING PLACE</p> <p>114 FORSYTH STREET, GREENOCK</p> <p>PLACE No. 1051</p>	<table> <tr> <td>Scale :</td><td>1:500</td><td>Date :</td><td>NOV 2010</td></tr> <tr> <td>Prepared by :</td><td>R. MACKAY</td><td>Checked by :</td><td></td></tr> <tr> <td>Drawn by :</td><td>R. MACKAY</td><td>Approved by :</td><td></td></tr> <tr> <td>Drawing No. :</td><td></td><td>File No. :</td><td>19/12</td></tr> </table>	Scale :	1:500	Date :	NOV 2010	Prepared by :	R. MACKAY	Checked by :		Drawn by :	R. MACKAY	Approved by :		Drawing No. :		File No. :	19/12
Scale :	1:500	Date :	NOV 2010																
Prepared by :	R. MACKAY	Checked by :																	
Drawn by :	R. MACKAY	Approved by :																	
Drawing No. :		File No. :	19/12																

Disabled Bays

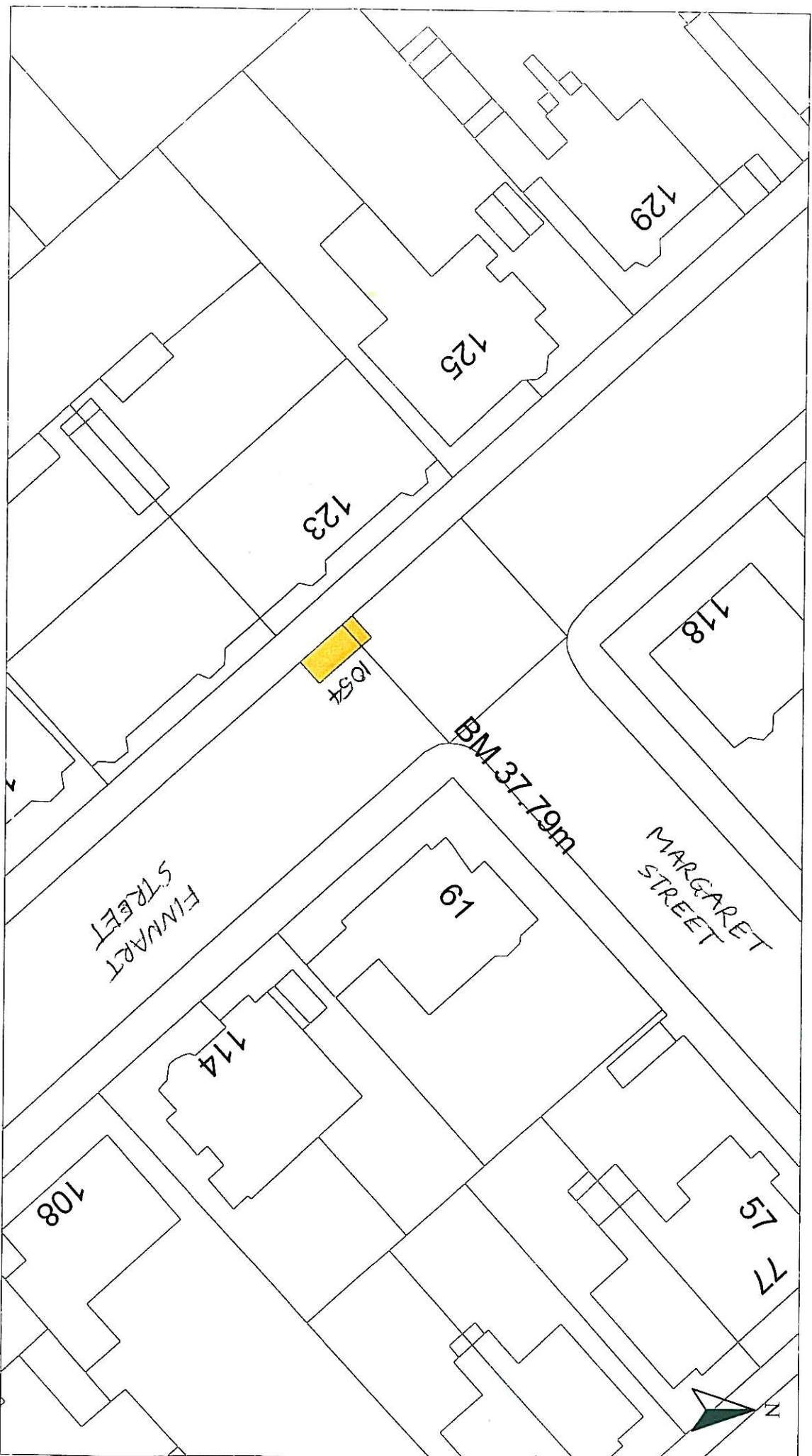

HEAD OF SERVICE
ALAN G BARNES MCIMM CENV

Disabled Bays
71 EAST HAMILTON STREET
GREENOCK, PA15 2UA

Reproduced from Ordnance Survey mapping with the permission
of the Controller of Her Majesty's Stationery Office. Crown
Copyright. Unauthorised reproduction infringes Crown Copyright
and may result in prosecution or legal proceedings.

Licence No. LA03097L



DISABLED PERSONS' PARKING PLACE

123 FINNART STREET, GREENOCK
PLACE No 1054

Scale : 1:500

Prepared by : R. MACKAY

Drawn by : R. MACKAY

Drawing No. :

Date : NOV 2010

Checked by :

Approved by :

File No. :

19/12

Inverclyde council

ENVIRONMENTAL & COMMERCIAL SERVICES

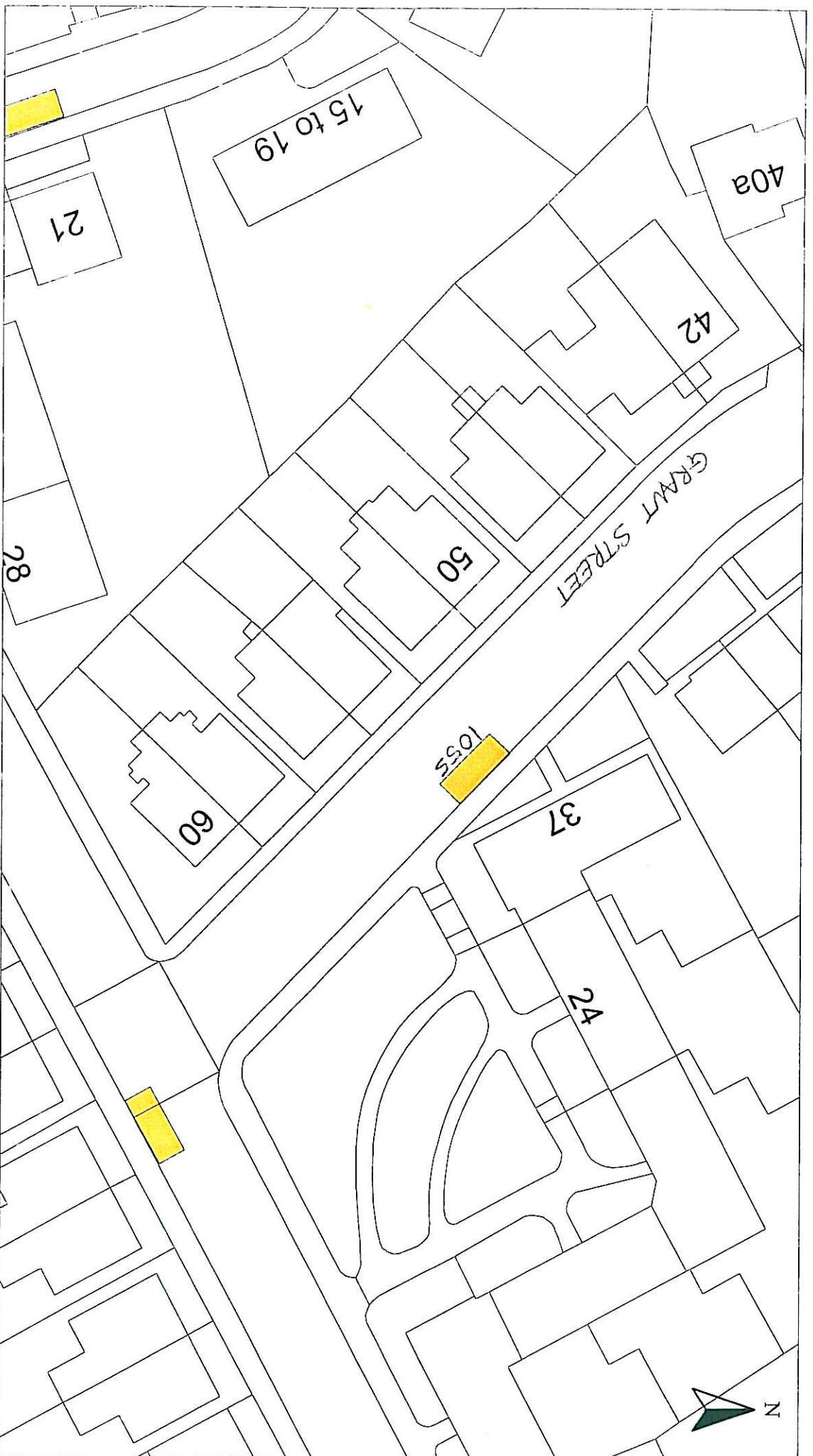

HEAD OF SERVICE ALAN G BARNES MCIVM CEnv		<small>Reproduced from Ordnance Survey mapping with the permission of the Controller at Her Majesty's Stationery Office. Crown Copyright. Unauthorised reproduction infringes Crown Copyright and may result in prosecution or legal proceedings.</small> Licence No. LA03097L  Ordnance Survey	
Disabled Bays 71 EAST HAMILTON STREET GREENOCK, PA15 2UA		DISABLED PERSONS' PARKING PLACE 37 GRANT STREET, GREENOCK PLACE No. 1055	
Scale :	1:500	Date :	NOV 2010
Prepared by :	R. MACKAY	Checked by :	
Drawn by :	R. MACKAY	Approved by :	
Drawing No. :		File No. :	19/12

Inverclyde council

ENVIRONMENTAL & COMMERCIAL SERVICES

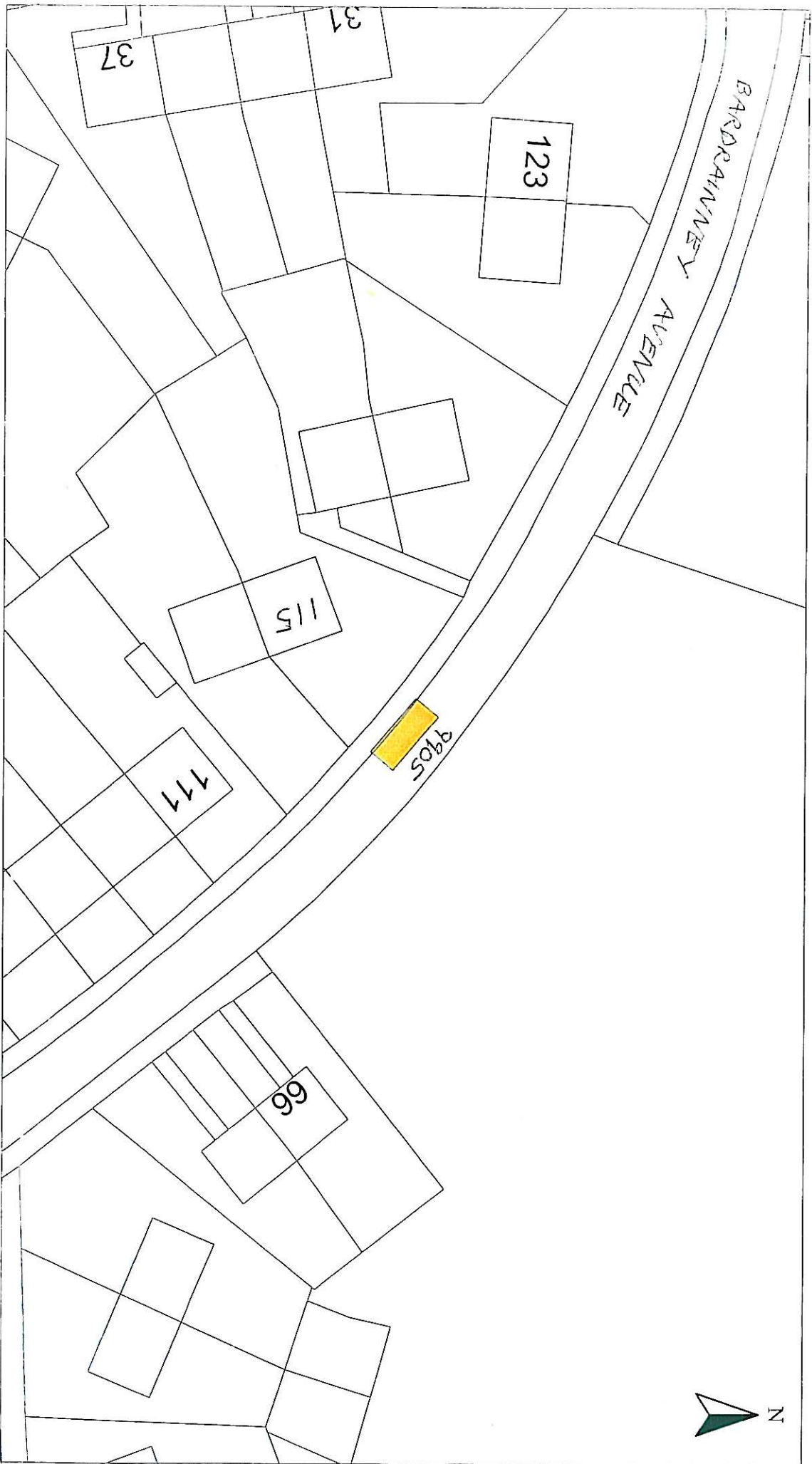

HEAD OF SERVICE ALAN G BARNES MCIMW CEnv		<small>Reproduced from Ordnance Survey mapping with the permission of the Controller of Her Majesty's Stationary Office. Crown Copyright. Unauthorised reproduction infringes Crown Copyright and may result in prosecution or legal proceedings.</small> Licence No. LA03097L  Ordnance Survey	
DISABLED PERSONS' PARKING PLACE 115 BARDRAINNEY AVE, PORT GLASGOW PLACE No. 9905 REVOCATION		Scale : 1:500	Date : NOV 2010
Disabled Bays	71 EAST HAMILTON STREET GREENOCK, PA15 2UA	Prepared by : R. MACKAY Drawn by : R. MACKAY Drawing No. :	Checked by : Approved by : File No. : 19/12

Inverclyde council

ENVIRONMENTAL & COMMERCIAL SERVICES

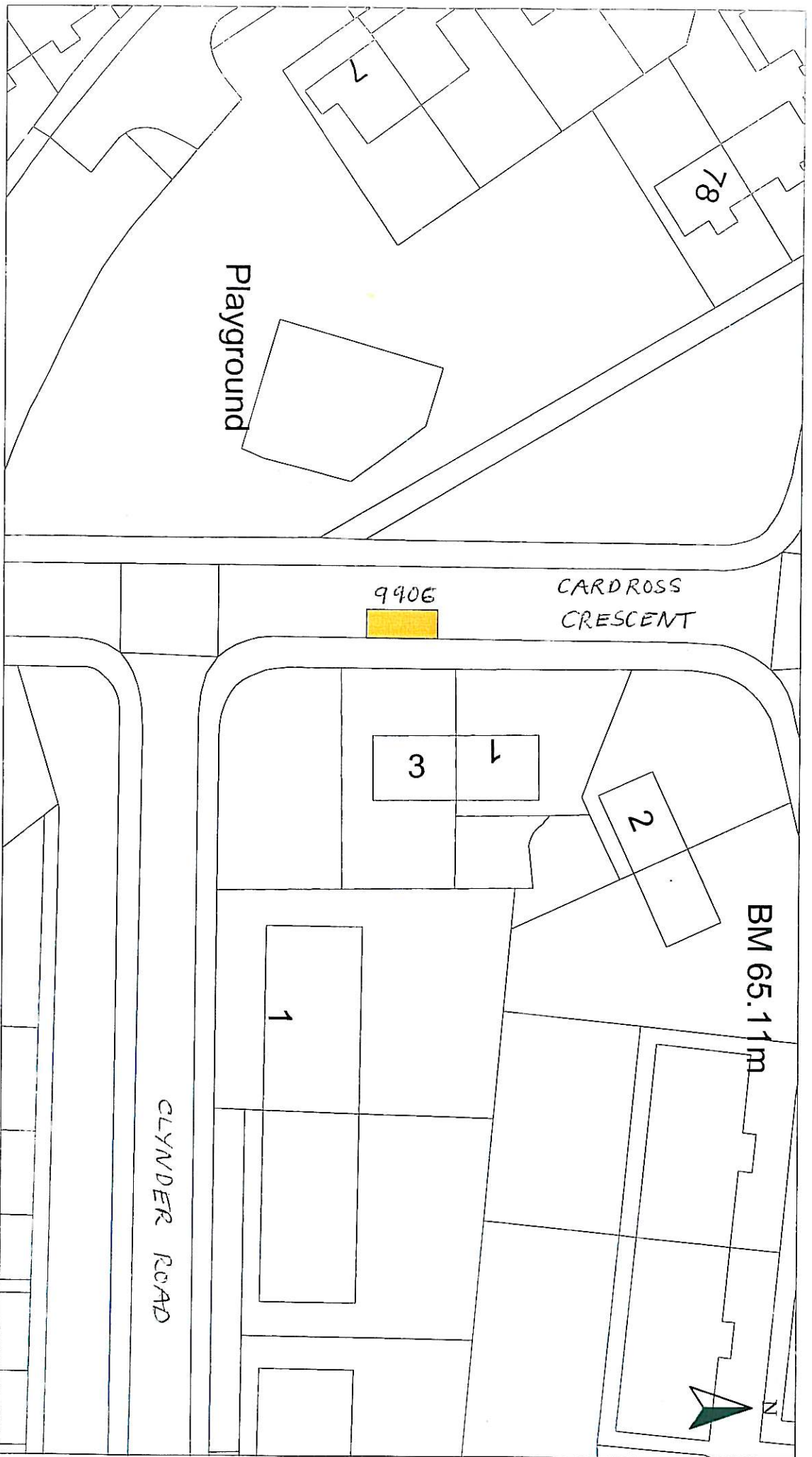

HEAD OF SERVICE
ALAN G BARNES MCWM CENV

Disabled Bays
71 EAST HAMILTON STREET
GREENOCK, PA15 2UA

Reproduced from Ordnance Survey mapping with the permission
of the Controller of Her Majesty's Stationery Office. Crown
Copyright. Unauthorised reproduction may result in legal proceedings
and may result in prosecution or legal proceedings.

Licence No. LA03097L



DISABLED PERSONS' PARKING PLACE

3 CARDROSS CRESCENT, GREENOCK
PLACE No. 9906 REVOCATION

Scale : 1:500

Prepared by : R. MACKAY

Drawn by : R. MACKAY

Drawing No. :

Date : NOV 2010

Checked by :

Approved by :

File No. :

19/12

Inverclyde council

ENVIRONMENTAL & COMMERCIAL SERVICES

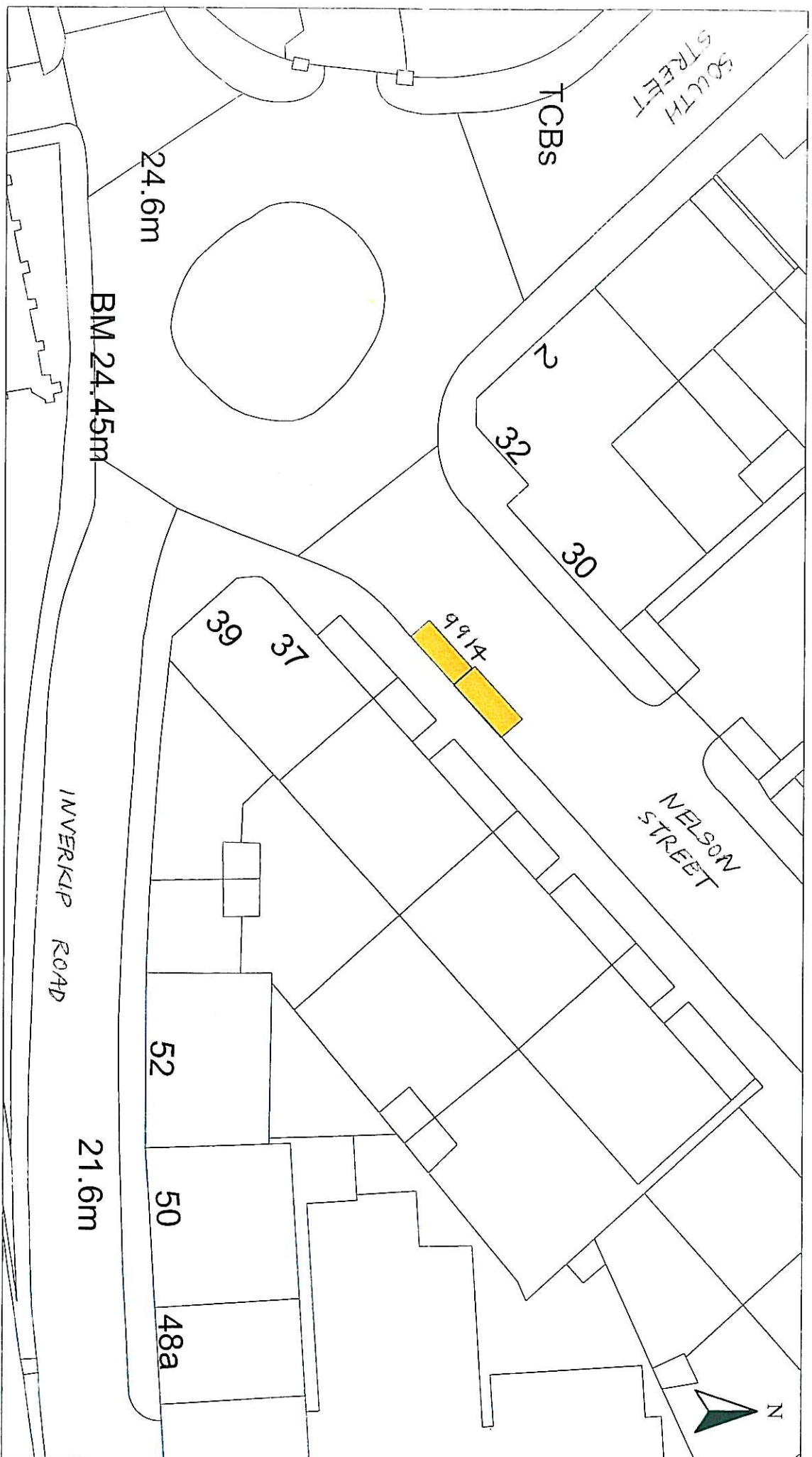

HEAD OF SERVICE ALAN G BARNES MCWM CEIV		<small>Reproduced from Ordnance Survey mapping with the permission of the Ordnance Survey. Copyright Crown Copyright. Unauthorised reproduction is prohibited. Crown copyright and may result in prosecution or legal proceedings.</small>	
Disabled Bays	71 EAST HAMILTON STREET GREENOCK, PA15 2UA	Licence No. LA03097L 	DISABLED PERSONS' PARKING PLACE 37 NELSON STREET, GREENOCK PLACE No. 9914 REVOCATION
Scale : 1:500		Date : NOV 2010	
Prepared by : R. MACKAY		Checked by :	
Drawn by : R. MACKAY		Approved by :	
Drawing No. :		File No. : 19/12	

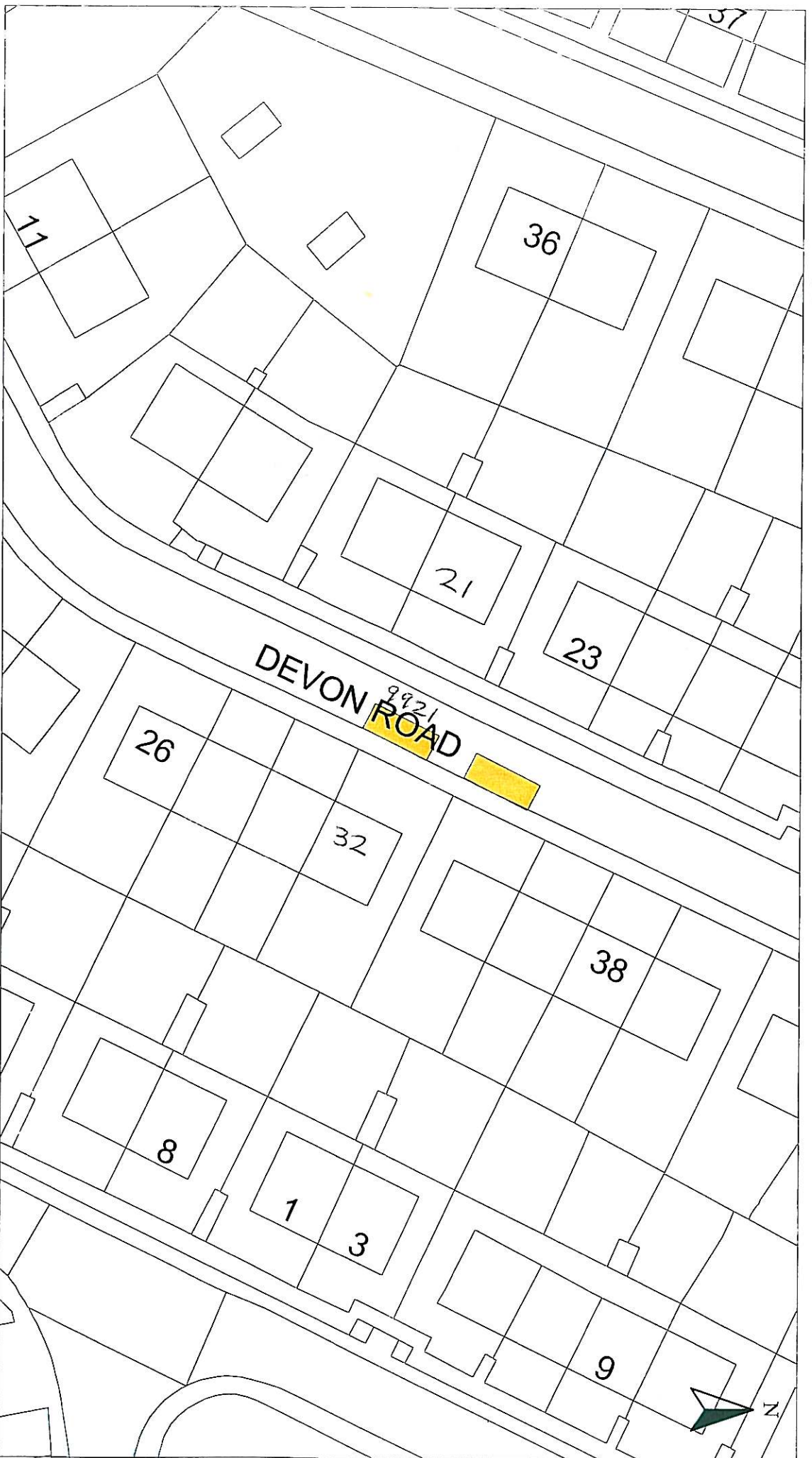

HEAD OF SERVICE ALAN G BARNES MCIMM CENV		Reproduced from Ordnance Survey mapping with the permission of the Controller of Her Majesty's Stationery Office. Crown Copyright. Unauthorised reproduction infringes Crown Copyright and may result in prosecution or legal proceedings.	
Disabled Bays 71 EAST HAMILTON STREET GREENOCK, PA15 2UA		Licence No. LA03097L 	
DISABLED PERSONS' PARKING PLACE 21 DEVON ROAD, GREENOCK PLACE No. 9921 REVOCATION			
Scale :	1:500	Date :	NOV 2010
Prepared by :	R. MACKAY	Checked by :	
Drawn by :	R. MACKAY	Approved by :	
Drawing No. :		File No. :	19/12

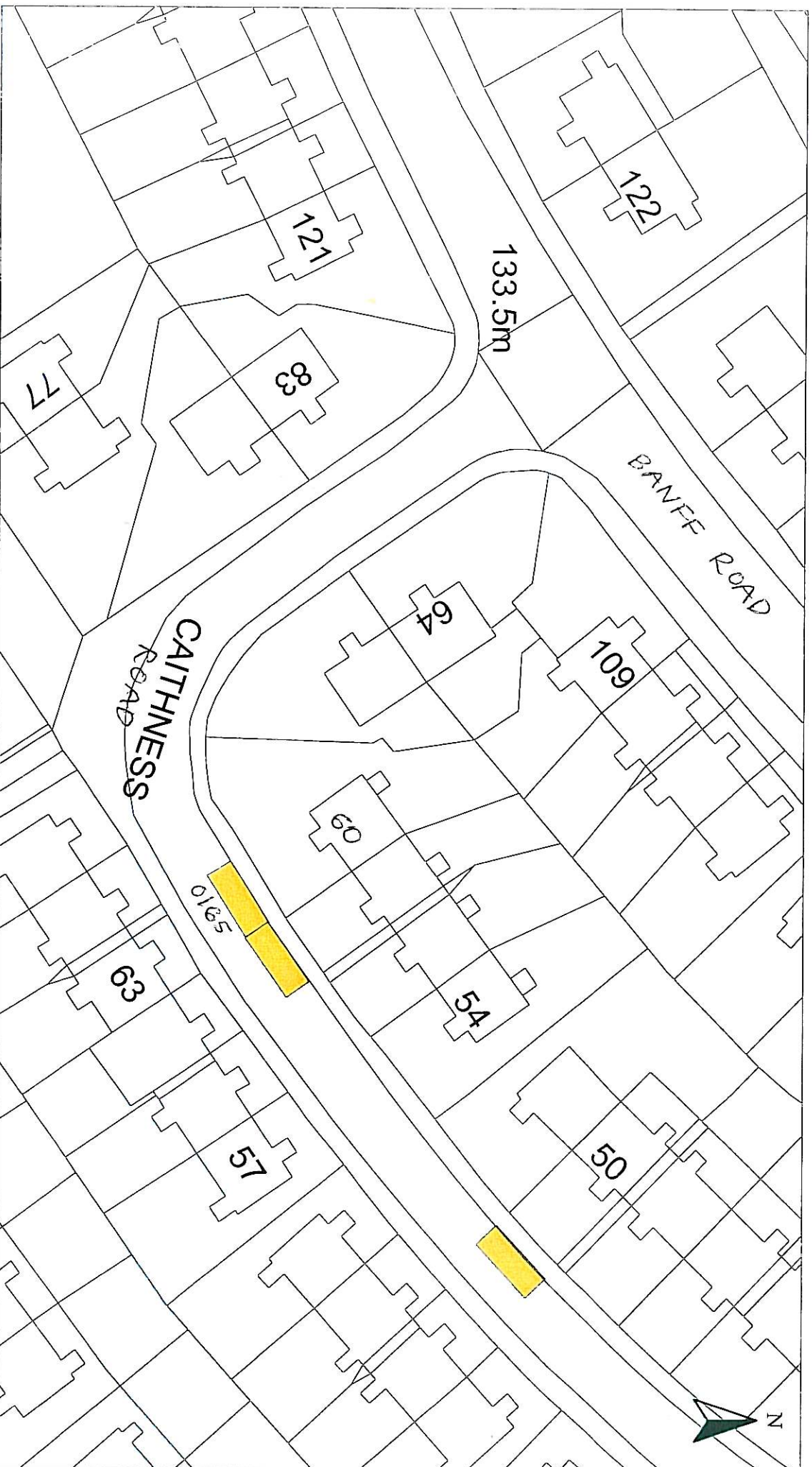

HEAD OF SERVICE
ALAN G BARNES MCIMM CENV

Disabled Bays
71 EAST HAMILTON STREET
GREENOCK, PA15 2UA

*produced from Ordnance Survey mapping with the permission of the Controller of Her Majesty's Stationary Office. Crown Copyright. Unauthorised reproduction infringes Crown Copyright and may result in prosecution or legal proceedings

Licence No. LA03097L



DISABLED PERSONS' PARKING PLACE

60 CAITHNESS ROAD, GREENOCK
PLACE No. 0165 REVOCATION

Scale : 1:500

Prepared by : R. MACKAY

Drawn by : R. MACKAY

Drawing No. :

Date : NOV 2010

Checked by :

Approved by :

File No. : 19/12



HEAD OF SERVICE ALAN G BARNES MCIMM CENV		Disabled Bays	
71 EAST HAMILTON STREET GREENOCK, PA15 2UA		Licence No. LA03097L 	
DISABLED PERSONS' PARKING PLACE 42 FINLAYSTONE ROAD, KILMACOLM PLACE No. 0411 REVOCATION		Scale : 1:500 Prepared by : R. MACKAY Drawn by : R. MACKAY Drawing No. :	
		Date : NOV 2010 Checked by : Approved by : File No. : 19/12	

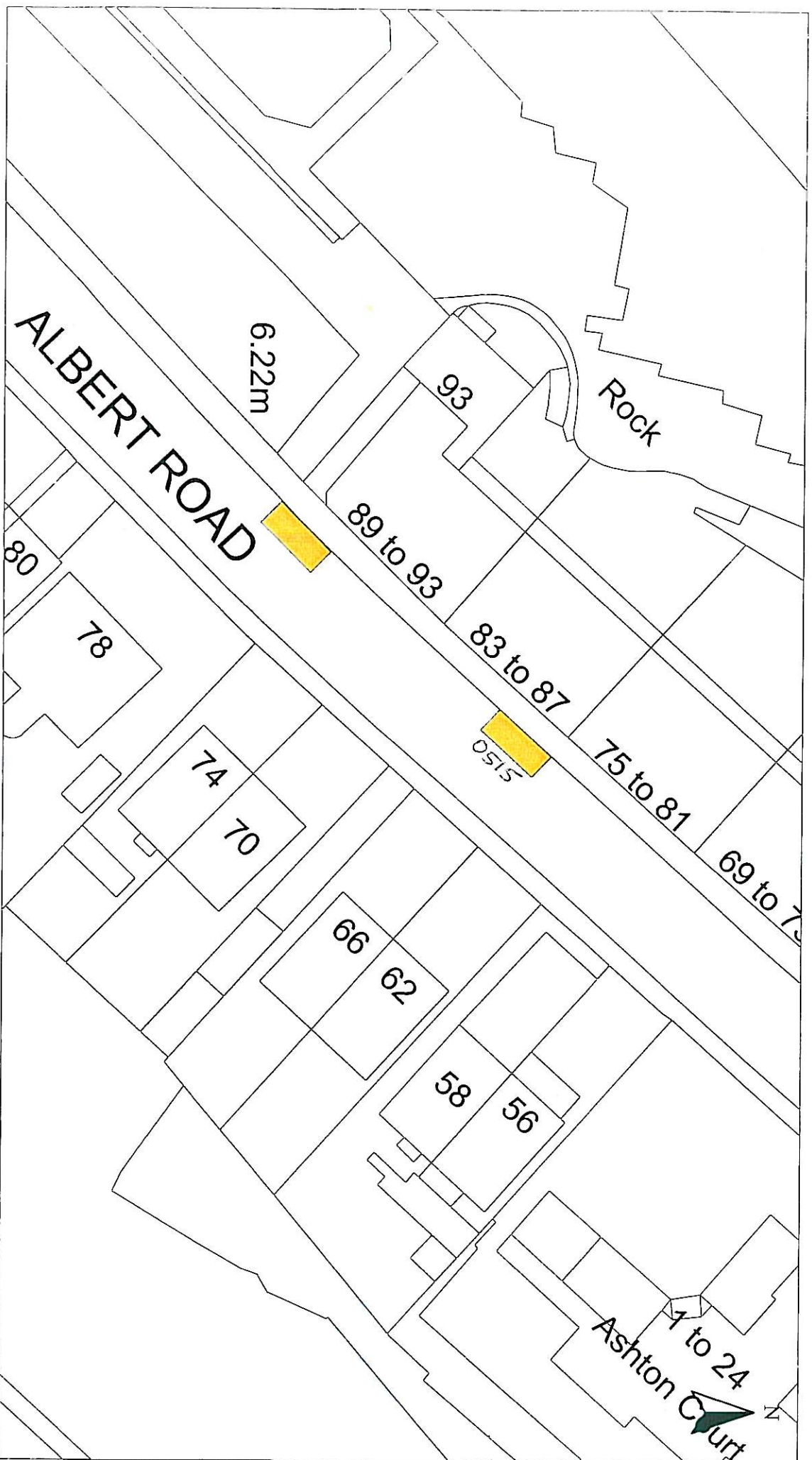

HEAD OF SERVICE
ALAN G BARNES MCIMM CEnv

Disabled Bays

71 EAST HAMILTON STREET
GREENOCK, PA15 2UA

Reproduced from Ordnance Survey mapping with the permission of the Controller of Her Majesty's Stationary Office. Crown Copyright. All Rights Reserved. No part of this publication may be reproduced in any form or by any means electronic or mechanical, including photocopying and recording, or by any information storage or retrieval system, without prior permission in writing from the Ordnance Survey. Any person who infringes the above copyright may be liable to criminal proceedings and civil proceedings for damages and may be liable to prosecution or legal proceedings.

Licence No. LA03097L



DISABLED PERSONS' PARKING PLACE

85 ALBERT ROAD, GOUROCK
PLACE No. 0515 REVOCATION

Scale : 1:500

Date : NOV 2010

Prepared by : R. MACKAY

Checked by :

Drawn by : R. MACKAY

Approved by :

Drawing No. :

File No. : 19/12

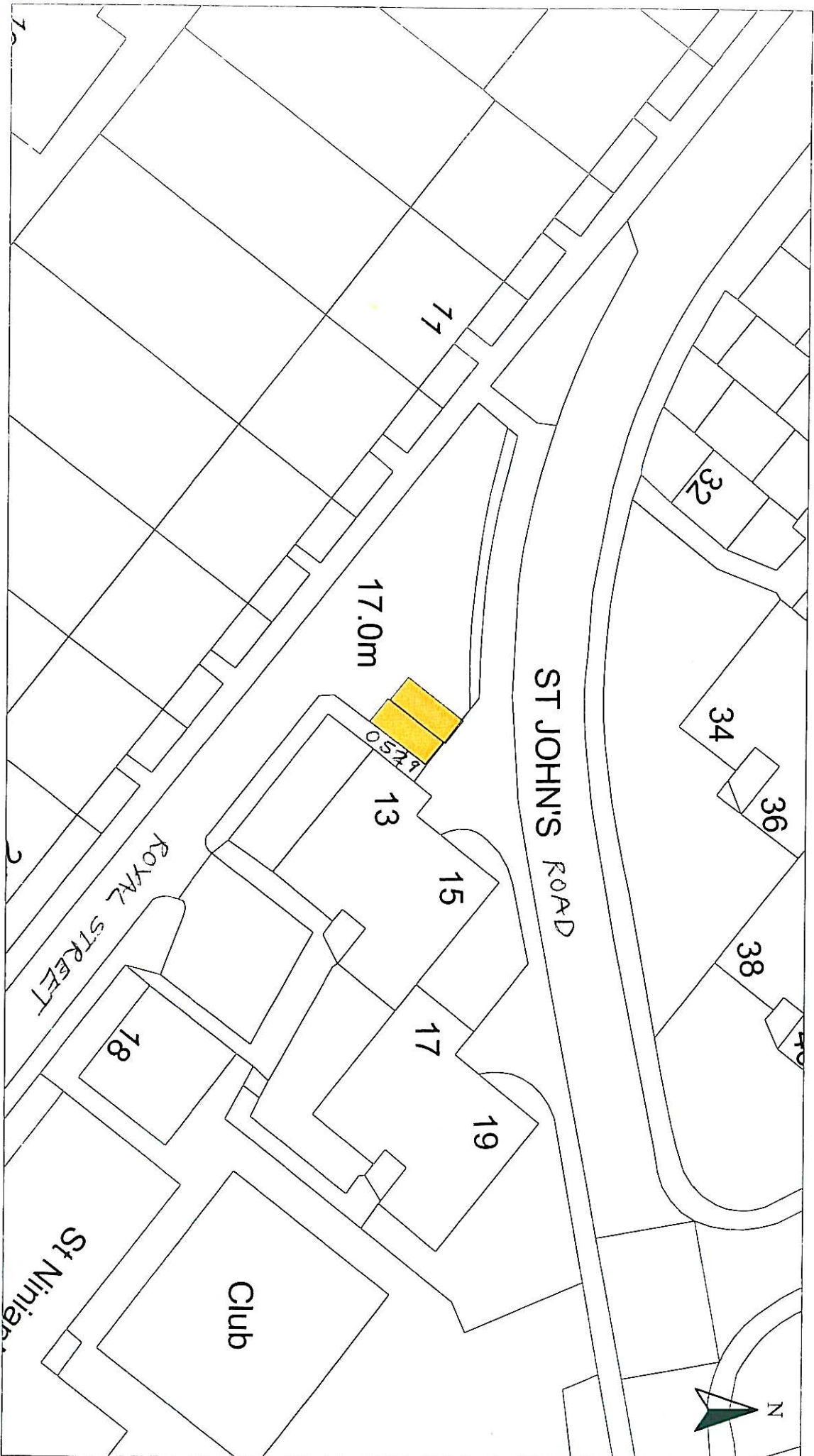

HEAD OF SERVICE
ALAN G BARNES MCWM CENV

Disabled Bays

71 EAST HAMILTON STREET
GREENOCK, PA15 2UA

Reproduced from Ordnance Survey mapping with the permission
of the Controller of Her Majesty's Stationery Office. Crown
Copyright. Unauthorised reproduction infringes Crown Copyright
and may result in prosecution or legal proceedings.

Licence No. LA03097L



DISABLED PERSONS' PARKING PLACE

13B ST JOHN'S ROAD, GOUROCK
PLACE No. 0529 REVOCATION

Scale : 1:500

Prepared by : R. MACKAY

Drawn by : R. MACKAY

Drawing No. :

Date : NOV 2010

Checked by :

Approved by :

File No. : 19/12

Inverclyde council

ENVIRONMENTAL & COMMERCIAL SERVICES

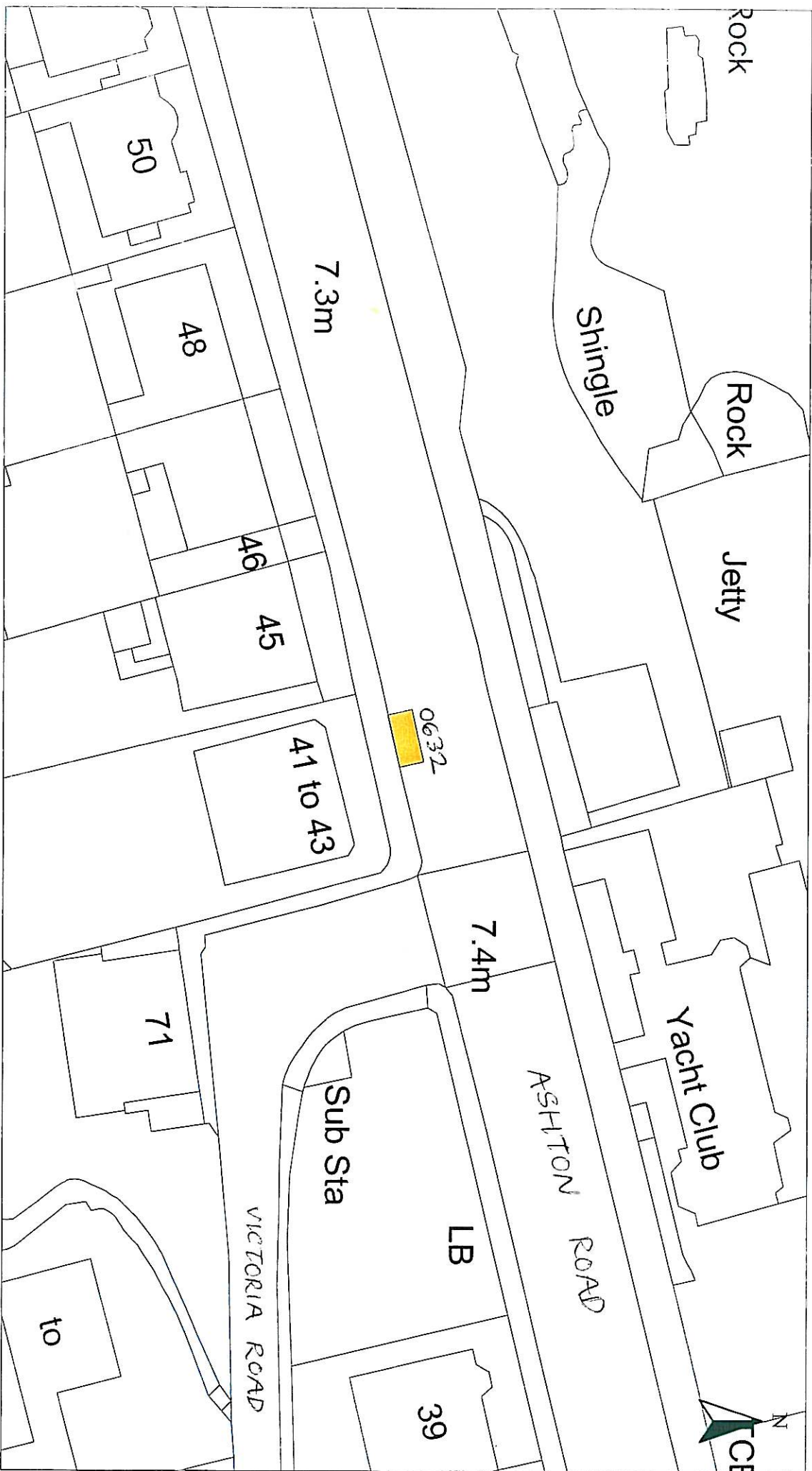

HEAD OF SERVICE ALAN G BARNES MCIMM CEnv		Retrieved from Ordnance Survey mapping with the permission of the Controller of Her Majesty's Stationery Office. Crown Copyright. All reproduction infringes Crown Copyright and may result in prosecution or legal proceedings.	
Disabled Bays 71 EAST HAMILTON STREET GREENOCK, PAIS 2UA		Licence No. LA03097L 	
DISABLED PERSONS' PARKING PLACE 41 ASHTON ROAD, GOUROCK PLACE No. 0632 REVOCATION			
Scale :	1:500	Date :	NOV 2010
Prepared by :	R. MACKAY	Checked by :	
Drawn by :	R. MACKAY	Approved by :	
Drawing No. :		File No. :	19/12

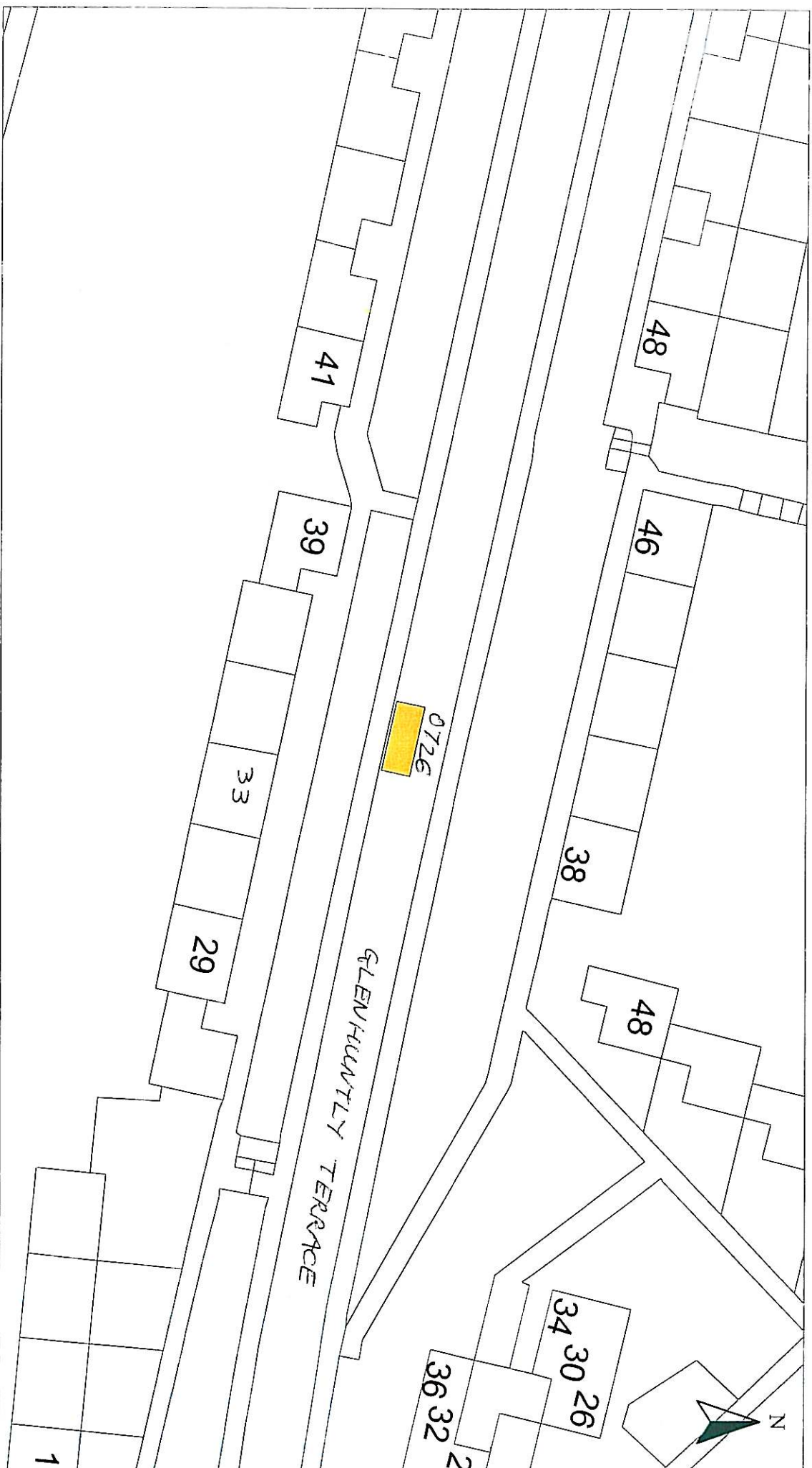

HEAD OF SERVICE
ALAN G BARNES MCIVM CEnv

Disabled Bays
71 EAST HAMILTON STREET
GREENOCK, PA15 2UA

Reproduced from Ordnance Survey mapping with the permission
of the Controller at Her Majesty's Stationery Office. Crown
Copyright. Unauthorised reproduction infringes Crown Copyright
and may result in prosecution or legal proceedings.

Licence No. LA03097L



DISABLED PERSONS' PARKING PLACE
33 GLENHUNTLY TERR, PORT GLASGOW
PLACE No. 0726 REVOCATION

Scale : 1:500

Date : NOV 2010

Prepared by : R. MACKAY

Checked by :

Drawn by : R. MACKAY

Approved by :

Drawing No. :

File No. : 19/12

council

ENVIRONMENTAL & COMMERCIAL SERVICES

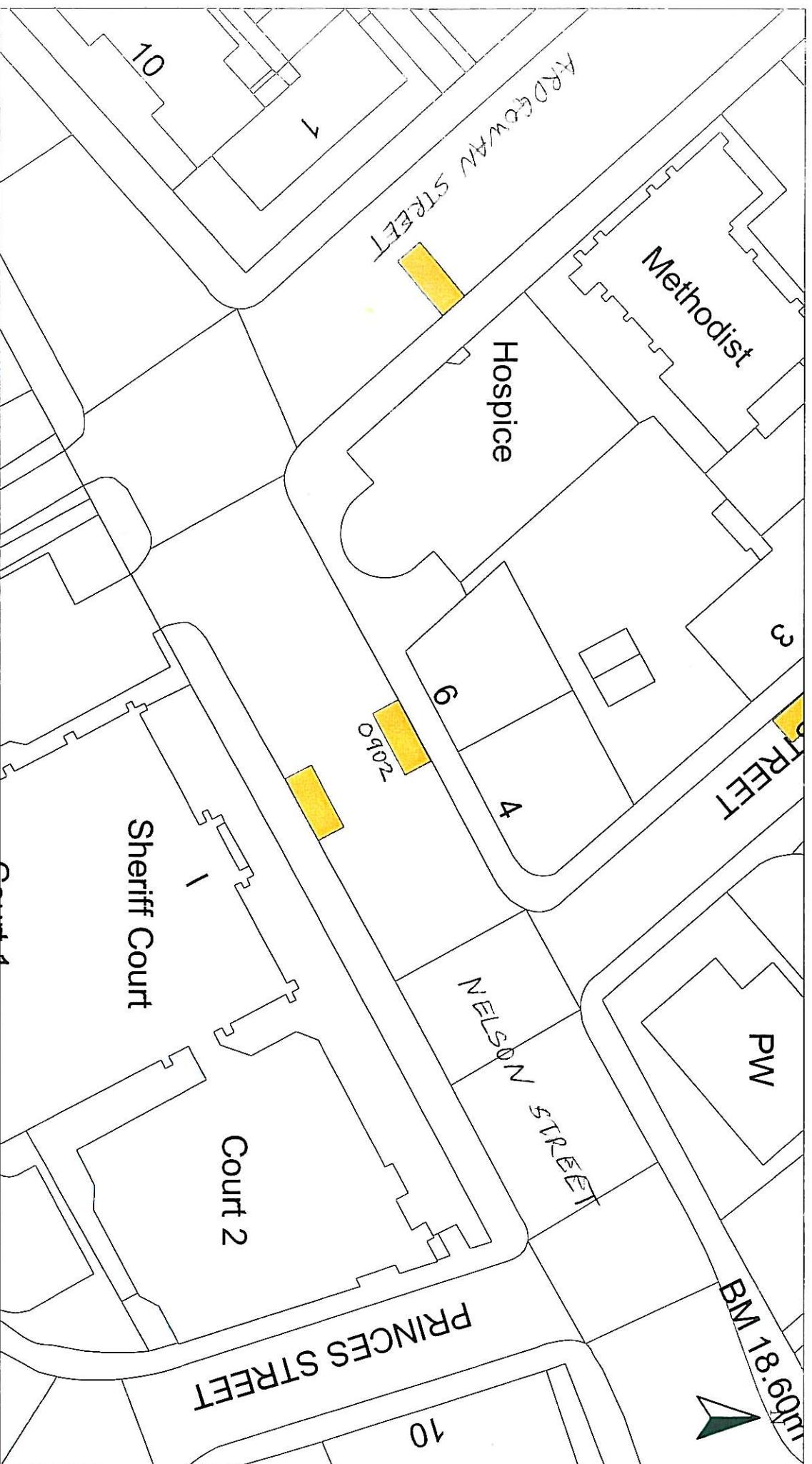

HEAD OF SERVICE
ALAN G BARNES MCJWM Cenv

Disabled Bays

71 EAST HAMILTON STREET
GREENOCK, PA15 2UA

Reproduced from Ordnance Survey mapping with the permission of the Controller of Her Majesty's Stationery Office. Crown Copyright. Unauthorised reproduction infringes Crown Copyright and may result in prosecution or legal proceedings.

Licence No. LA03097L



DISABLED PERSONS' PARKING PLACE

6 NELSON STREET, GREENOCK
PLACE No. 0902 REVOCATION

Scale : 1:500

Date : NOV 2010

Prepared by : R. MACKAY

Checked by :

Drawn by : R. MACKAY

Approved by :

Drawing No. :

File No. :	19/12
------------	-------

Inverclyde council

ENVIRONMENTAL & COMMERCIAL SERVICES

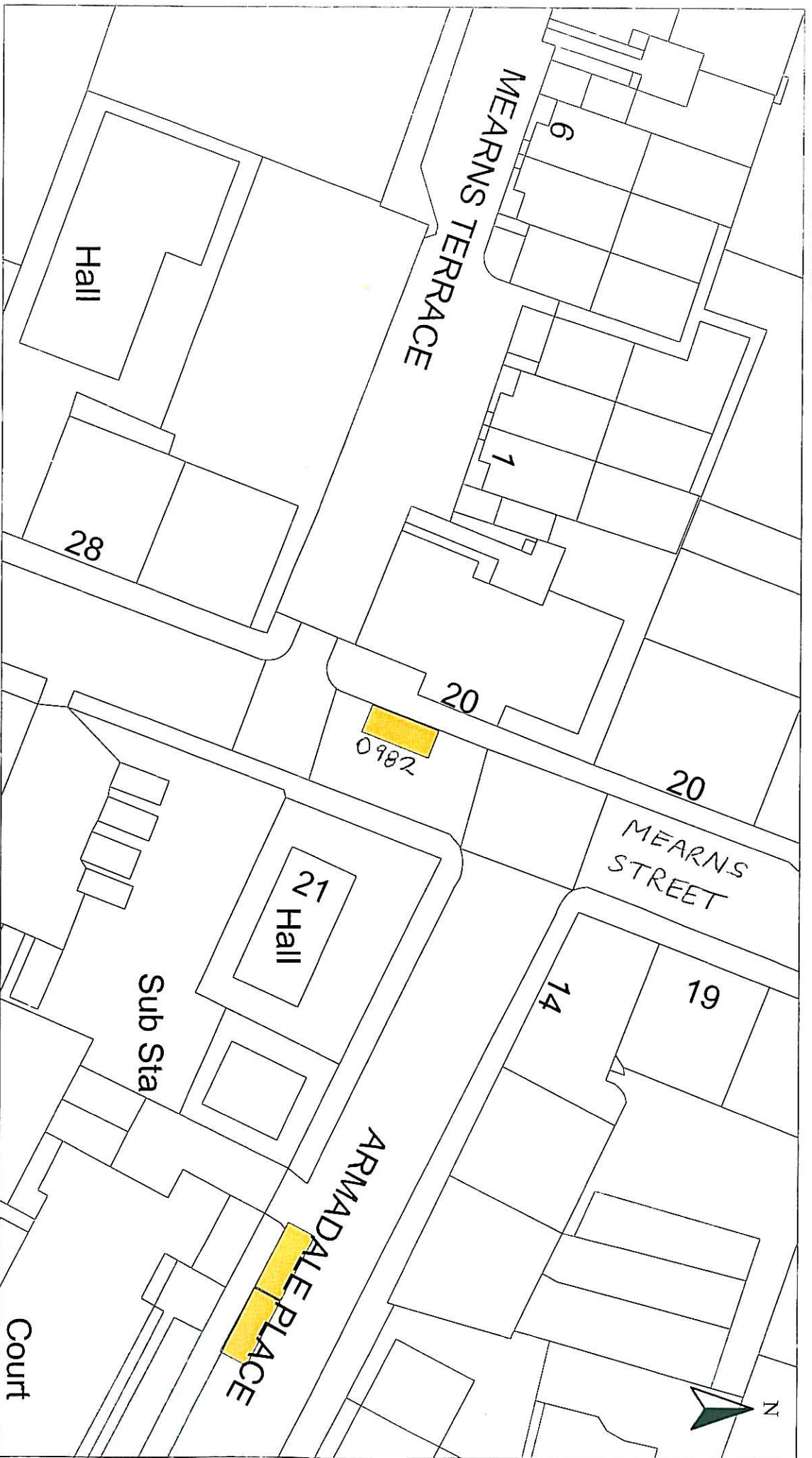

HEAD OF SERVICE ALAN G BARNES MCIVM CENV		Prepared from Ordnance Survey mapping with the permission of the Controller of Her Majesty's Stationery Office. Copyright. Unauthorised reproduction infringes Crown Copyright and may result in prosecution or legal proceedings. Licence No. LA03097L 																	
Disabled Bays	71 EAST HAMILTON STREET GREENOCK, PA15 2UA	DISABLED PERSONS' PARKING PLACE 22 MEARN'S STREET, GREENOCK PLACE No. 0982 REVOCATION	<table> <tr> <td>Scale :</td><td>1:500</td><td>Date :</td><td>NOV 2010</td></tr> <tr> <td>Prepared by :</td><td>R. MACKAY</td><td>Checked by :</td><td></td></tr> <tr> <td>Drawn by :</td><td>R. MACKAY</td><td>Approved by :</td><td></td></tr> <tr> <td>Drawing No. :</td><td></td><td>File No. :</td><td>19/12</td></tr> </table>	Scale :	1:500	Date :	NOV 2010	Prepared by :	R. MACKAY	Checked by :		Drawn by :	R. MACKAY	Approved by :		Drawing No. :		File No. :	19/12
Scale :	1:500	Date :	NOV 2010																
Prepared by :	R. MACKAY	Checked by :																	
Drawn by :	R. MACKAY	Approved by :																	
Drawing No. :		File No. :	19/12																