

---

<b>Report To:</b>	<b>ENVIRONMENT &amp; REGENERATION COMMITTEE</b>	<b>Date: 15 JANUARY 2015</b>
<b>Report By:</b>	<b>CORPORATE DIRECTOR, ENVIRONMENT, REGENERATION &amp; RESOURCES</b>	<b>Report No: LP/003/15</b>
<b>Contact Officer:</b>	<b>JOANNA DALGLEISH</b>	<b>Contact No: 01475 712123</b>
<b>Subject:</b>	<b>PROPOSED TRAFFIC REGULATION ORDER – DISABLED PERSONS’ PARKING PLACES (ON-STREET) ORDER NO. 3 2014</b>	

---

## **1.0 PURPOSE**

- 1.1 Local Authorities are empowered to make Orders under the Road Traffic Regulation Act 1984 as amended and under the Council’s Scheme of Administration the Head of Environmental and Commercial Services is responsible for the making, implementation and review of Traffic Management Orders and Traffic Regulation Orders.
- 1.2 The provision of on-street parking places for use by disabled drivers, who are the holders of a Disabled Person’s Badge, is regulated by The Disabled Persons’ Parking Places (Scotland) Act 2009. Inverclyde Council is required to promote a Traffic Regulation Order to regulate the use of such parking places.

## **2.0 SUMMARY**

- 2.1 In order to comply with The Disabled Persons’ Parking Places (Scotland) Act 2009, Section 5, it is proposed to introduce a Traffic Regulation Order to accompany the provision of parking places for the disabled. This will restrict parking to drivers displaying a Disabled Person’s Badge only and will enable the Police to enforce such restrictions. The proposed Order will also revoke those parking places no longer required in order to maximise street parking capacity.

## **3.0 RECOMMENDATION**

- 3.1 That the Committee recommend to The Inverclyde Council the making of the Traffic Regulation Order – Disabled Persons’ Parking Places (On-Street) Order No. 3 2014 and remit it to the Head of Environmental and Commercial Services and the Head of Legal and Property Services to arrange for its implementation.

**Gerard Malone**  
**Legal and Property Services**

## **4.0 BACKGROUND**

- 4.1 Currently no Traffic Regulation Orders exist at the locations shown in the Order which would prohibit the allocation of parking places for Disabled Person's Badge holders.
- 4.2 No objections were received to the proposed Order.
- 4.3 The Committee is asked to note that, if approved, the Order may not be implemented until the making of the Order has been advertised to allow any persons who so wish a period of six weeks to question the validity of the Order in terms of the Road Traffic Regulation Act 1984.

## **5.0 IMPLICATIONS**

### **Finance**

- 5.1 There are no financial implications arising from this report.

### **Legal**

- 5.2 There are no legal implications arising from this report.

### **Human Resources**

- 5.3 There are no HR implications arising from this report.

### **Equalities**

- 5.4 There are no equalities implications arising from this report.

### **Repopulation**

- 5.5 There are no repopulation implications arising from this report.

## **6.0 CONSULTATIONS**

- 6.1 The proposals have been advertised in the Greenock Telegraph and full details of the proposals have been made available for public inspection during normal office hours at the offices of the Head of Environmental and Commercial Services, the Head of Legal and Property Services and at Central, Port Glasgow, Gourrock and Inverkip & Wemyss Bay Libraries. A copy of the draft Order is appended hereto for Members' information. Appendix 1

## **7.0 LIST OF BACKGROUND PAPERS**

- 7.1 None

**THE INVERCLYDE COUNCIL**  
**DISABLED PERSONS' PARKING PLACES**  
**(ON-STREET) ORDER NO. 3 2014**  
**TRAFFIC REGULATION ORDER**

DRAFT

**THE INVERCLYDE COUNCIL**  
**DISABLED PERSONS' PARKING PLACES (ON-STREET)**  
**ORDER NO. 3 2014**

The Inverclyde Council in exercise of the powers conferred on them by Sections 32(1) of the Road Traffic Regulation Act 1984 ("the Act") and of all other enabling powers and after consultation with the Chief Constable of Police Scotland in accordance with Part III of Schedule 9 to the Act hereby make the following Order.

1. This Order may be cited as "The Inverclyde Council Disabled Persons' Parking Places (On-Street) Order No. 3 2014" and shall come into operation on #####.
2. In this Order the following expressions have the meanings hereby assigned to them
  - "Council" means The Inverclyde Council or its successors as Roads Authority;
  - "disabled person's badge" means:
    - (a) a badge issued under Section 21 of the Chronically Sick and Disabled Persons Act 1970 (as amended);
    - (b) a badge issued under a provision of the law of Northern Ireland corresponding to that section; or
    - (c) a badge issued by any member State other than the United Kingdom for purposes corresponding to the purposes for which badges under that section are issued;and has not ceased to be in force.
  - "disabled person's vehicle" means a vehicle lawfully displaying a disabled person's badge;
  - "parking attendant" means a person employed in accordance with Section 63A of the Act to carry out the functions therein;
  - "parking place" means a place where a vehicle, or vehicles of any class, may wait i.e. the area of land specified in the Schedule for which the use as a parking place has been authorised by the Council under Section 32(1) of the Act;
  - "traffic sign" means a sign prescribed or authorised under Section 64 of the Act;
  - "vehicle" unless the context otherwise requires, means a vehicle of any description and includes a machine or implement of any kind drawn or propelled along roads whether or not by mechanical power;
3. Each area of road which is described in the Schedule and plans relative to this Order is hereby designated as a parking place.
4. The parking places designated in this Order shall only be used for the leaving of disabled persons' vehicles displaying a valid disabled person's badge.

5. The limits of each parking place designated in this Order shall be indicated on the carriageway as prescribed by The Traffic Signs Regulations and General Directions 2002.
6. Every vehicle left in any parking place designated in this Order shall stand such that no parking place is occupied by more than one vehicle and that every part of the vehicle is within the limits of the parking place provided that, where the length of a vehicle precludes compliance with this paragraph, such vehicle shall be deemed to be within the limits of a parking place if;
  - i. the extreme front portion or, as the case may be, the extreme rear portion of the vehicle is within 300mm of an indication on the carriageway provided under this Order in relation to the parking place; and
  - ii. the vehicle, or any part thereof, is not within the limits of any adjoining parking place.
7. Any person duly authorised by the Council or a police officer in uniform or a traffic warden or parking attendant may move or cause to be moved in case of any emergency, to any place they think fit, vehicles left in a parking place.
8. Any person duly authorised by the Council may suspend the use of a parking place or any part thereof whenever such suspension is considered reasonably necessary:
  - i. for the purpose of facilitating the movement of traffic or promoting its safety;
  - ii. for the purpose of any building operation, demolition, or excavation in or adjacent to the parking place or the laying, erection, alteration, removal or repair in or adjacent to the parking place of any sewer or of any main, pipe, apparatus for the supply of gas, water electricity or of any telecommunications apparatus, traffic sign or parking meter;
  - iii. for the convenience of occupiers of premises adjacent to the parking place on any occasion of the removal of furniture from one office or dwellinghouse to another or the removal of furniture from such premises to a depository or to such premises from a depository;
  - iv. on any occasion on which it is likely by reason of some special attraction that any street will be thronged or obstructed; or
  - v. for the convenience of occupiers of premises adjacent to the parking place at times of weddings or funerals or on other special occasions.
9. A police officer in uniform may suspend for not longer than twenty four hours the use of a parking place or part thereof whenever such suspension is considered reasonably necessary for the purpose of facilitating the movement of traffic or promoting its safety.

10. This Order insofar as it relates to the parking places to be revoked (R) and amended, as specified in the Schedule to this Order, partially revokes and amends The Inverclyde Council On-Street Parking Places (Without Charges) Order Nos: 01/2003, 01/2004, 02/2006, 01/2008, 02/2008, The Inverclyde Council Disabled Persons' Parking Places (On-Street) Order Nos: 01/2010, 02/2013, 04/2013 and 01/2014 respectively.

Sealed with the Common Seal of The Inverclyde Council and subscribed for them and on their behalf by ##

DRAFT

# INVERCLYDE COUNCIL

## DISABLED PERSONS' PARKING PLACES (ON-STREET) ORDER No.3 2014

### SCHEDULE

Rev A

All and whole that area of ground as described in Column 2 in the table below:

<u>Ref No.</u>	<u>Address of Disabled Person's Parking Place to be created or revoked ® "ex-adverso"</u>
1379	45 Glen Crescent, Inverkip
1381	55 Finch Road, Greenock
1401	0 Papermill Road, Greenock
1406	15 Newton Street, Greenock
1407	33 Cambridge Road, Greenock
1408	50 Brougham Street, Greenock
1410	0 Murdieston Street, Greenock
1412	49 Glenside Road, Port Glasgow
1416	46 Hillend Drive, Greenock
1417	75 Berwick Road, Greenock
1418	77 Langside Terrace, Port Glasgow
1420	19 Sandray Avenue, Port Glasgow
1422	16 Northfield Avenue, Port Glasgow
0260	142 Finnart Street, Greenock ®
0332	81 Waverley Street, Greenock ®
0635	13 Fort Matilda Place, Gourock ®
0750	16 Grenville Road, Gourock ®
0815	21A Margaret Street, Greenock ®
0945	141 Marloch Avenue, Port Glasgow ®
1257	18 Flatterton Road, Greenock ®
1304	14 Ashton Road, Gourock ®
1333	57 Bridgend Avenue, Port Glasgow ®
1343	28 Braeside Road, Greenock ®
1352	15 Ashton Road, Gourock ®

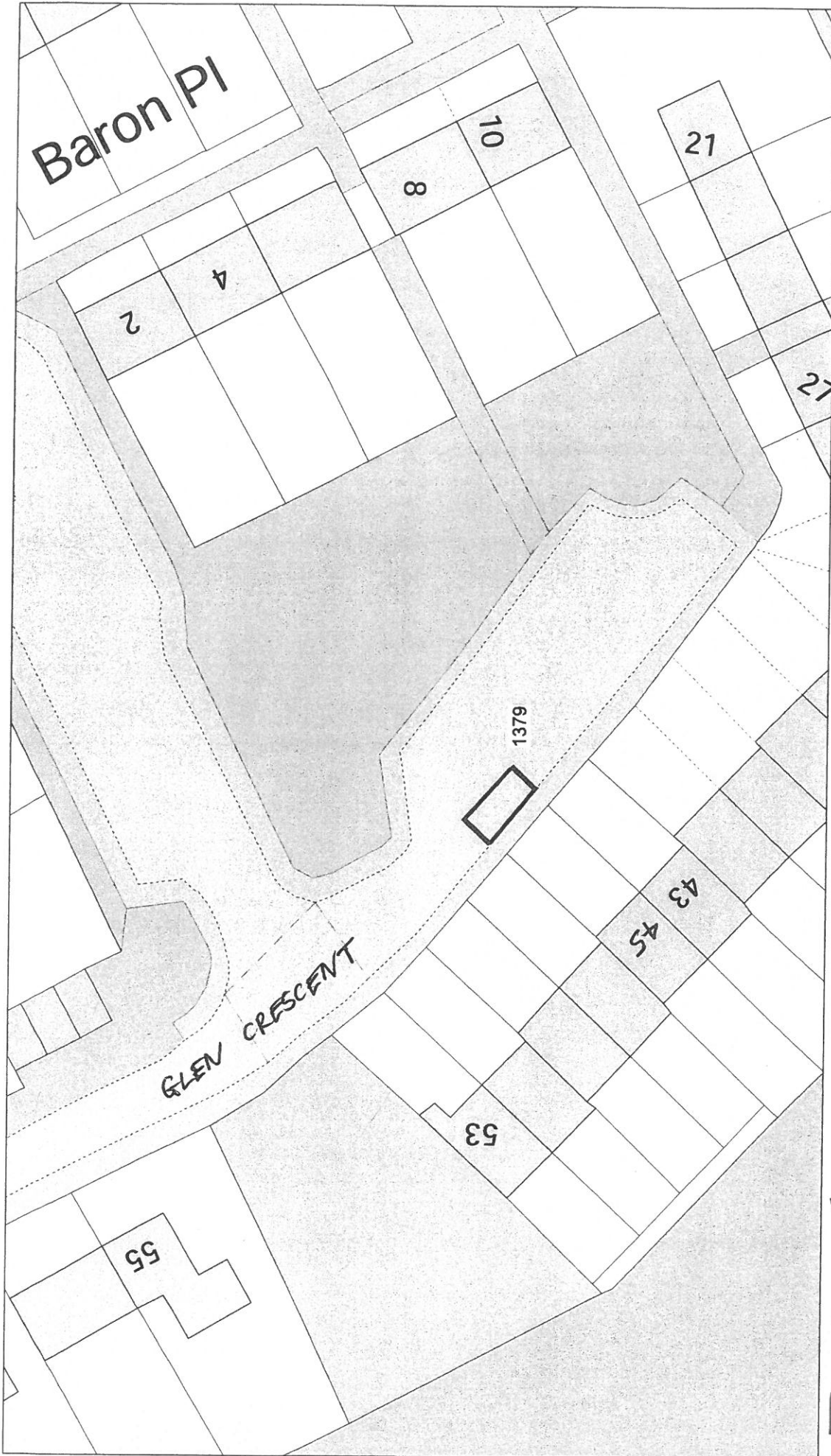

The material has been reproduced from Ordnance Survey digital map data with the permission of the Controller of Her Majesty's Stationery Office. © Crown copyright. Licence Number: nnnnnn

DISABLED PERSONS' PARKING PLACE  
 45 GLEN CRESCENT, INVERKIP  
 PLACE No. 1379



Sterling Court  
 Norton Road  
 Stevenage  
 Herts SG1 2JY  
 UK  
 Tel : +44 (0)1438 747996  
 Fax : +44 (0)1438 747997  
 E-mail: info@cadcorp.com





The material has been reproduced from Ordnance Survey maps with the permission of the Controller of Her Majesty's Stationery Office. License Number: 1000000000



DISABLED PERSONS' PARKING PLACE  
55 FINCH ROAD, GREENOCK  
PLACE No. 1381



Sterling Court  
Norton Road  
Stevenage  
Herts SG1 2JY  
UK  
Tel : +44 (0)1438 747996  
Fax : +44 (0)1438 747997  
E-mail: info@cadcorp.com

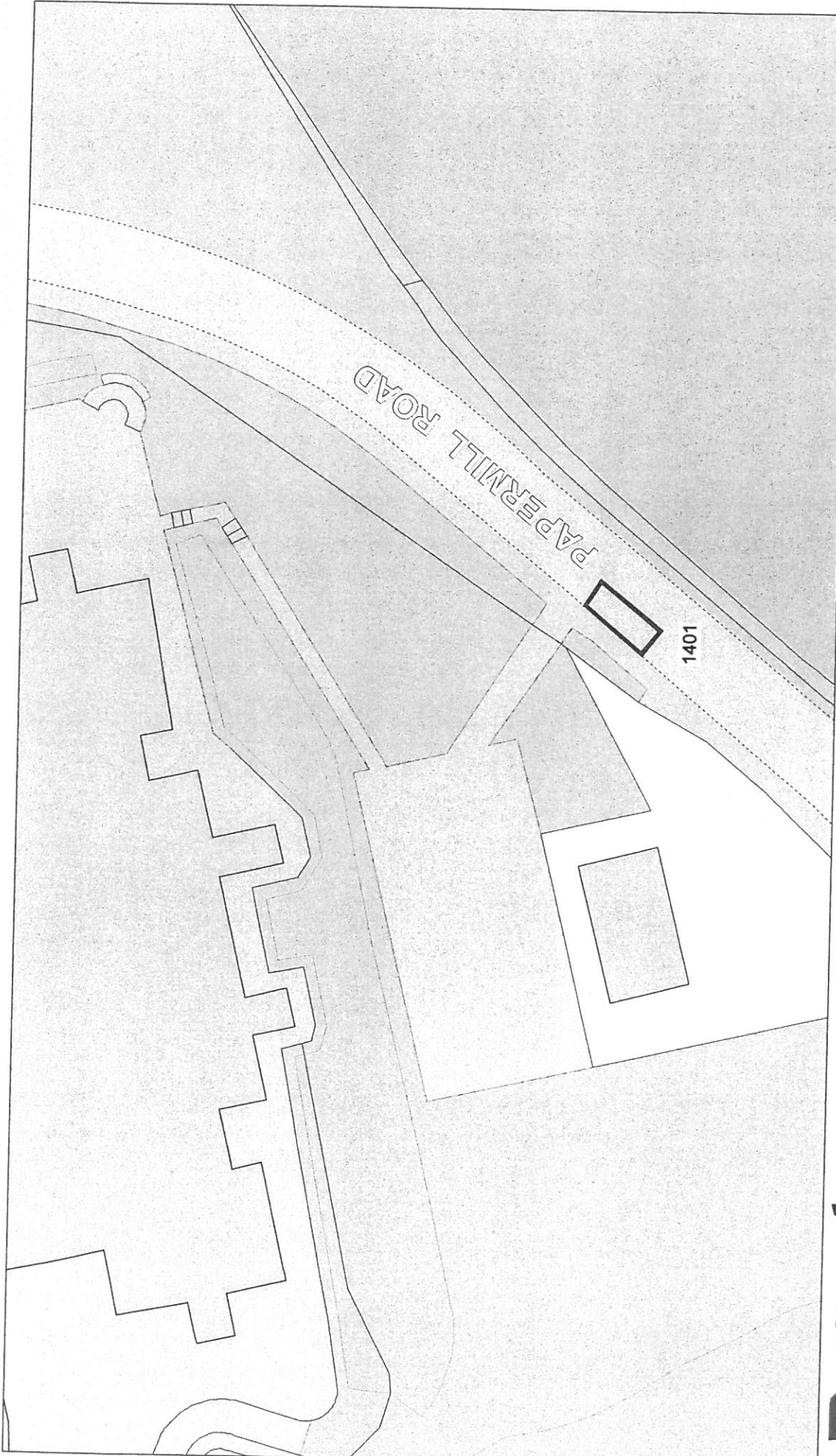

 Ordnance Survey  
Licensed System Supplier

This material has been reproduced from Ordnance Survey map data with the permission of the Controller of Her Majesty's Stationery Office.  
© Crown copyright.  
License Number: nnnnnn

 **Cadcorp**<sup>®</sup>

Sterling Court  
Norton Road  
Stevenage  
Herts SG1 2JY  
UK  
Tel : +44 (0)1438 747996  
Fax : +44 (0)1438 747997  
E-mail: info@cadcorp.com

**DISABLED PERSONS' PARKING PLACE**  
**PAPERMILL ROAD, GREENOCK**  
**PLACE No. 1401**

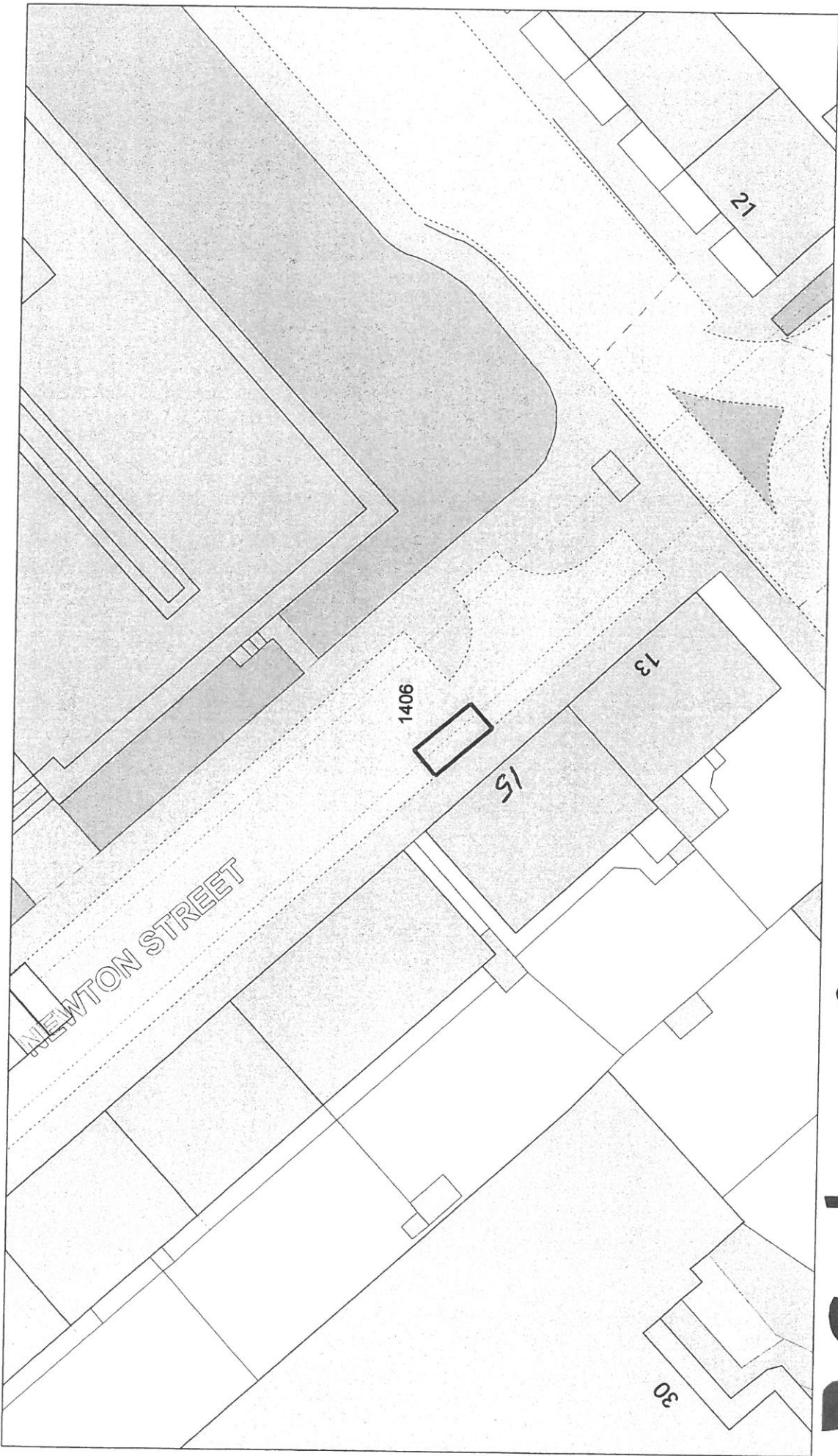



 Ordnance Survey  
 Licensed System Supplier

This material has been reproduced from  
 Ordnance Survey data with the  
 permission of the Controller of  
 Her Majesty's Stationery Office.  
 Licence Number: m98999

**DISABLED PERSONS' PARKING PLACE**  
**15 NEWTON STREET, GREENOCK**  
**PLACE No. 1406**

**Cadcorp®**

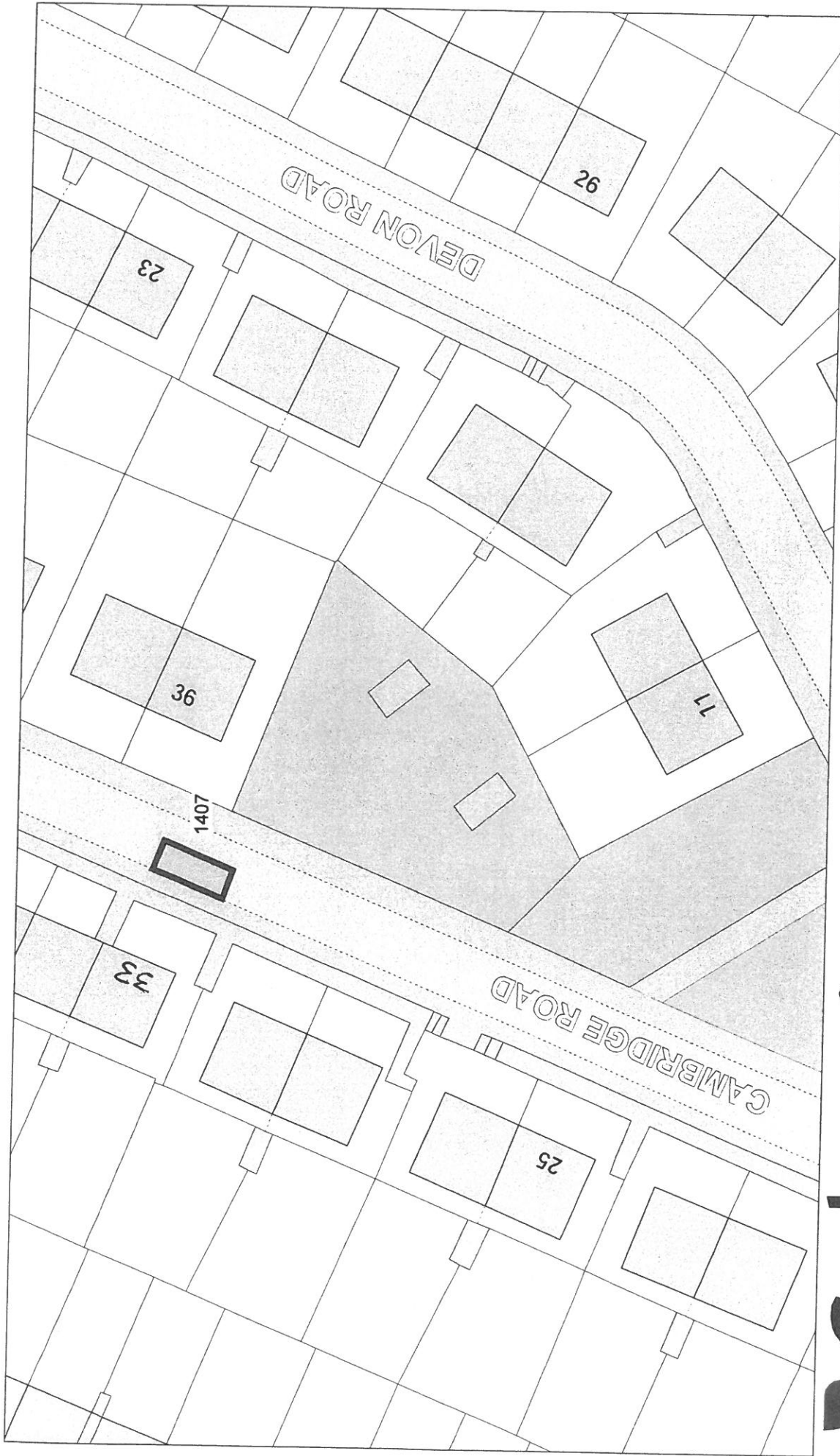
Sterling Court  
 Norton Road  
 Stevenage  
 Herts SG1 2JY  
 UK  
 Tel : +44 (0)1438 747996  
 Fax : +44 (0)1438 747997  
 E-mail : info@cadcorp.com



**Ordnance Survey**  
 Licensed System Supplier

The material has been reproduced from  
 Ordnance Survey digital map data with  
 the permission of the Controller of  
 Her Majesty's Stationery Office.  
 © Crown copyright. Licence Number: 100000000

**Cadcorp®**

Sterling Court  
 Norton Road  
 Stevenage  
 Herts SG1 2JY  
 UK

Tel : +44 (0)1438 747996  
 Fax : +44 (0)1438 747997  
 E-mail: info@cadcorp.com

DISABLED PERSONS' PARKING PLACE  
 33 CAMBRIDGE ROAD, GREENOCK  
 PLACE No. 1407

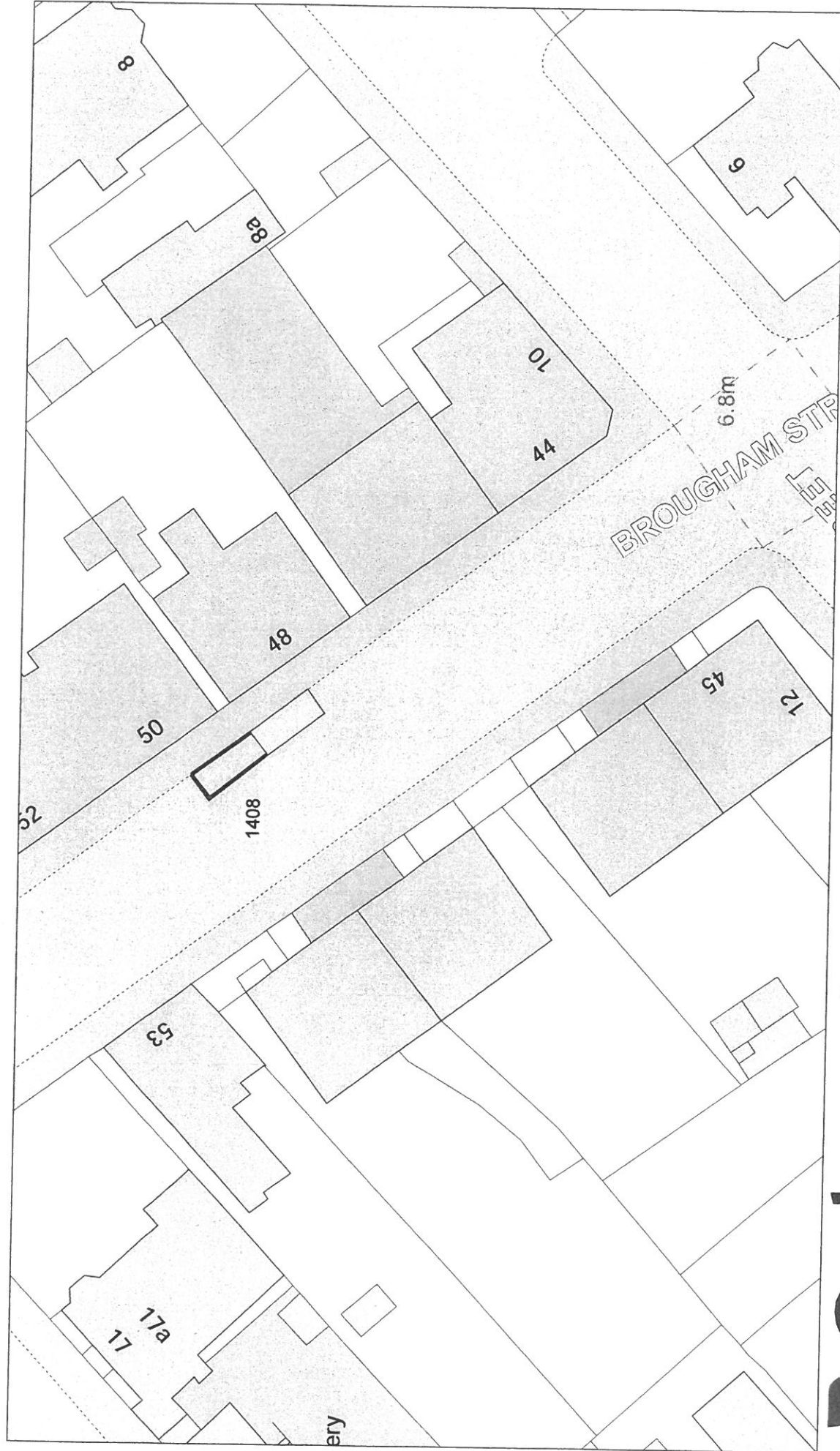

The material has been reproduced from Ordnance Survey digital map data with the permission of Her Majesty's Stationery Office.  
 © Crown copyright. Licence Number: INNNNN

**DISABLED PERSONS' PARKING PLACE**  
**50 BROUGHAM STREET, GREENOCK**  
**PLACE No. 1408**



Sterling Court  
 Norton Road  
 Stevenage  
 Herts SG1 2JY  
 UK  
 Tel : +44 (0)1438 747996  
 Fax : +44 (0)1438 747997  
 E-mail: info@cadcorp.com

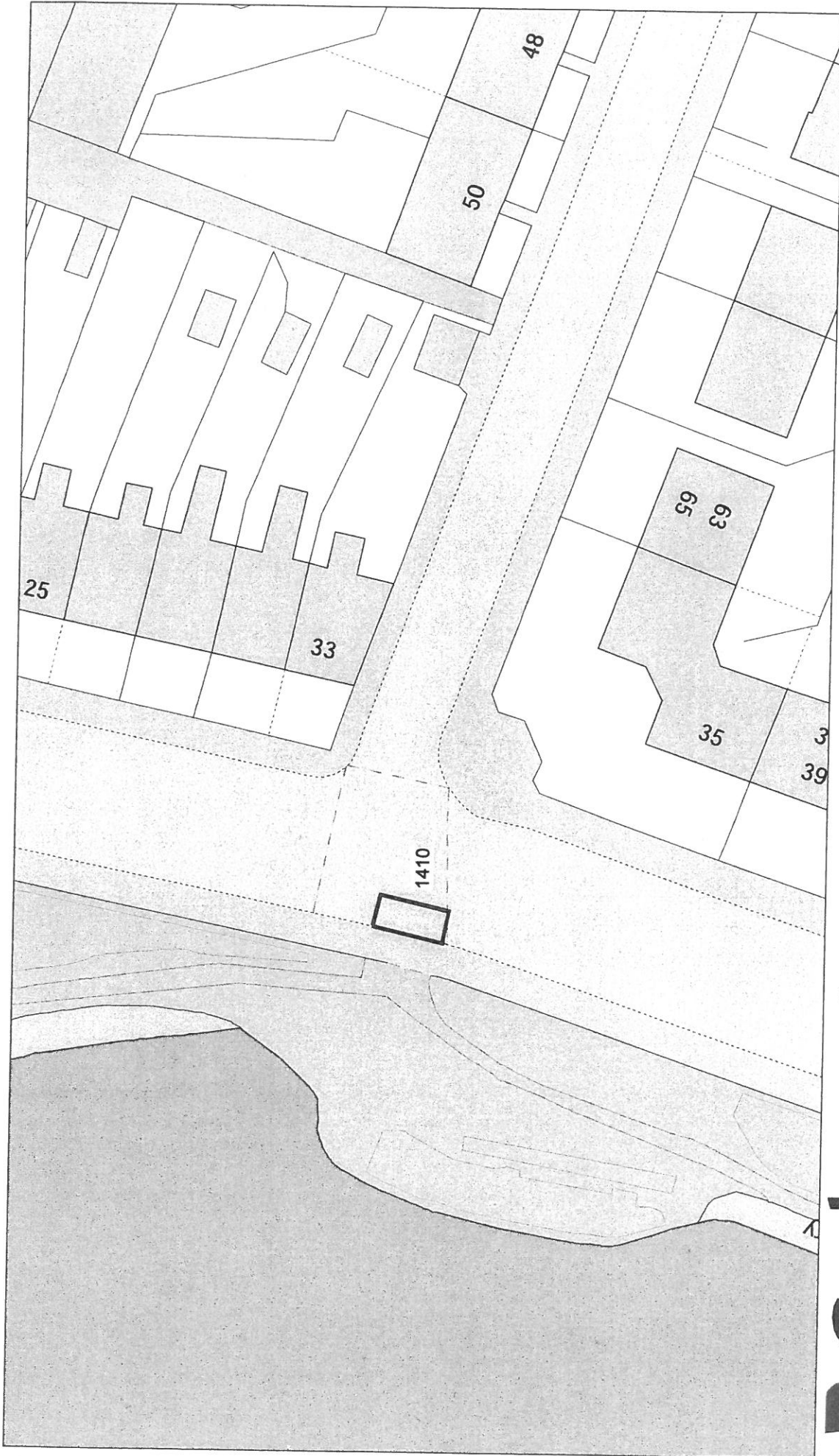

The material has been reproduced from  
Ordnance Survey digital map data with  
the permission of the Controller of  
Her Majesty's Stationery Office.  
© Crown copyright.  
License Number: 100000000

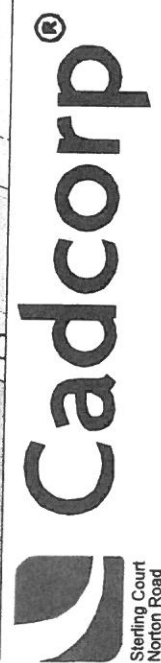

Sterling Court  
Norton Road  
Stevenage  
Herts SG1 2JY  
UK

Tel : +44 (0)1438 747996  
Fax : +44 (0)1438 747997  
E-mail: info@cadcorp.com

DISABLED PERSONS' PARKING PLACE  
MURDIESTON STREET, GREENOCK  
PLACE No. 1410

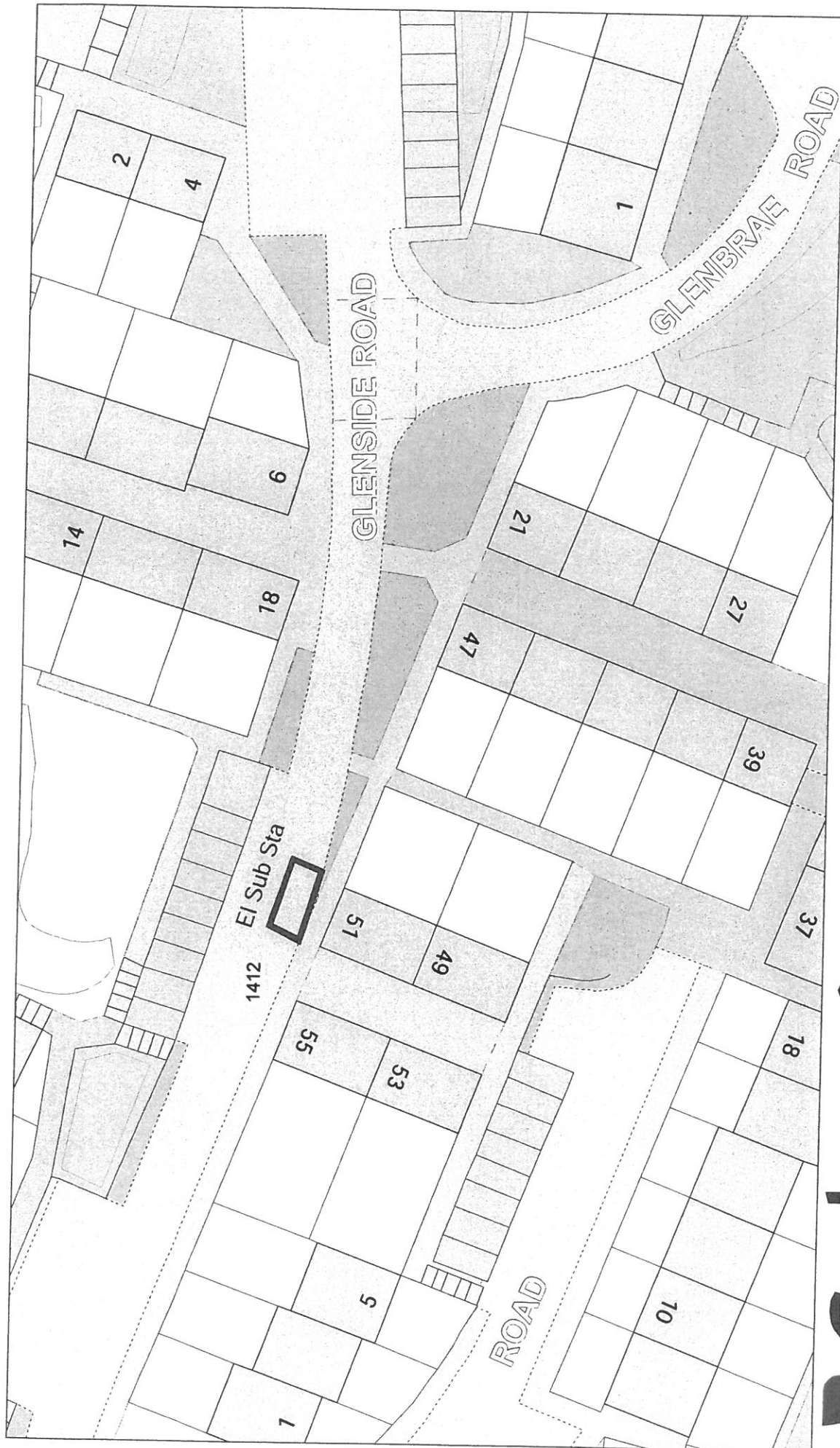

This material has been reproduced from Ordnance Survey digital map data with the permission of the Controller of Her Majesty's Stationery Office. © Crown copyright. License Number: nmmmm

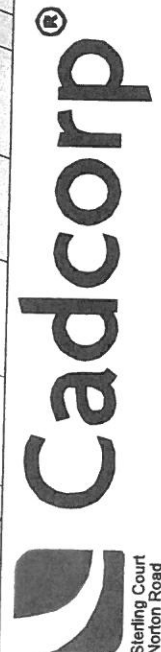

Sterling Court  
 Norton Road  
 Stevenage  
 Herts SG1 2JY  
 UK  
 Tel : +44 (0)1438 747996  
 Fax : +44 (0)1438 747997  
 E-mail: info@cadcorp.com

DISABLED PERSONS' PARKING PLACE  
 49 GLENSIDE ROAD, PORT GLASGOW  
 PLACE No. 1412

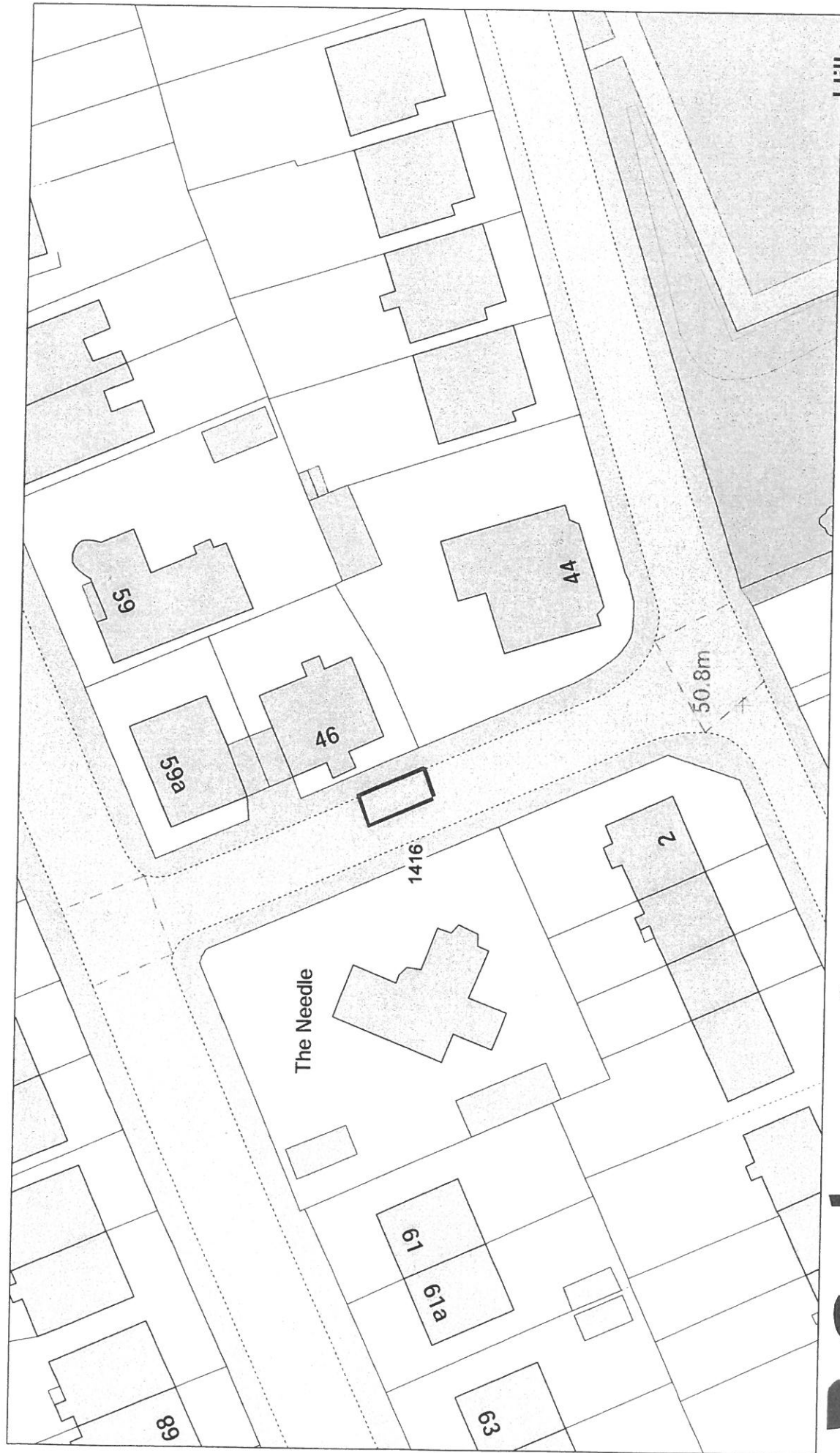

The material has been reproduced from Ordnance Survey digital map data with the permission of Ordnance Survey on behalf of Her Majesty's Stationary Office. © Crown copyright. Licence Number: 100000000

DISABLED PERSONS' PARKING PLACE  
 46 HILLEND DRIVE, GREENOCK  
 PLACE No. 1416



Sterling Court  
 Norton Road  
 Stevenage  
 Herts SG1 2JY  
 UK

Tel : +44 (0)1438 747996  
 Fax : +44 (0)1438 747997  
 E-mail: info@cadcorp.com





The material has been reproduced from  
Ordnance Survey digital map data with  
the permission of Her Majesty's Stationary Office.  
© Crown copyright.  
License Number: 1000000



Sterling Court  
Norton Road  
Stevenage  
Herts SG1 2JY  
UK

Tel : +44 (0)1438 747996  
Fax : +44 (0)1438 747997  
E-mail: info@cadcorp.com

DISABLED PERSONS' PARKING PLACE  
75 BERWICK ROAD, GREENOCK  
PLACE No. 1417

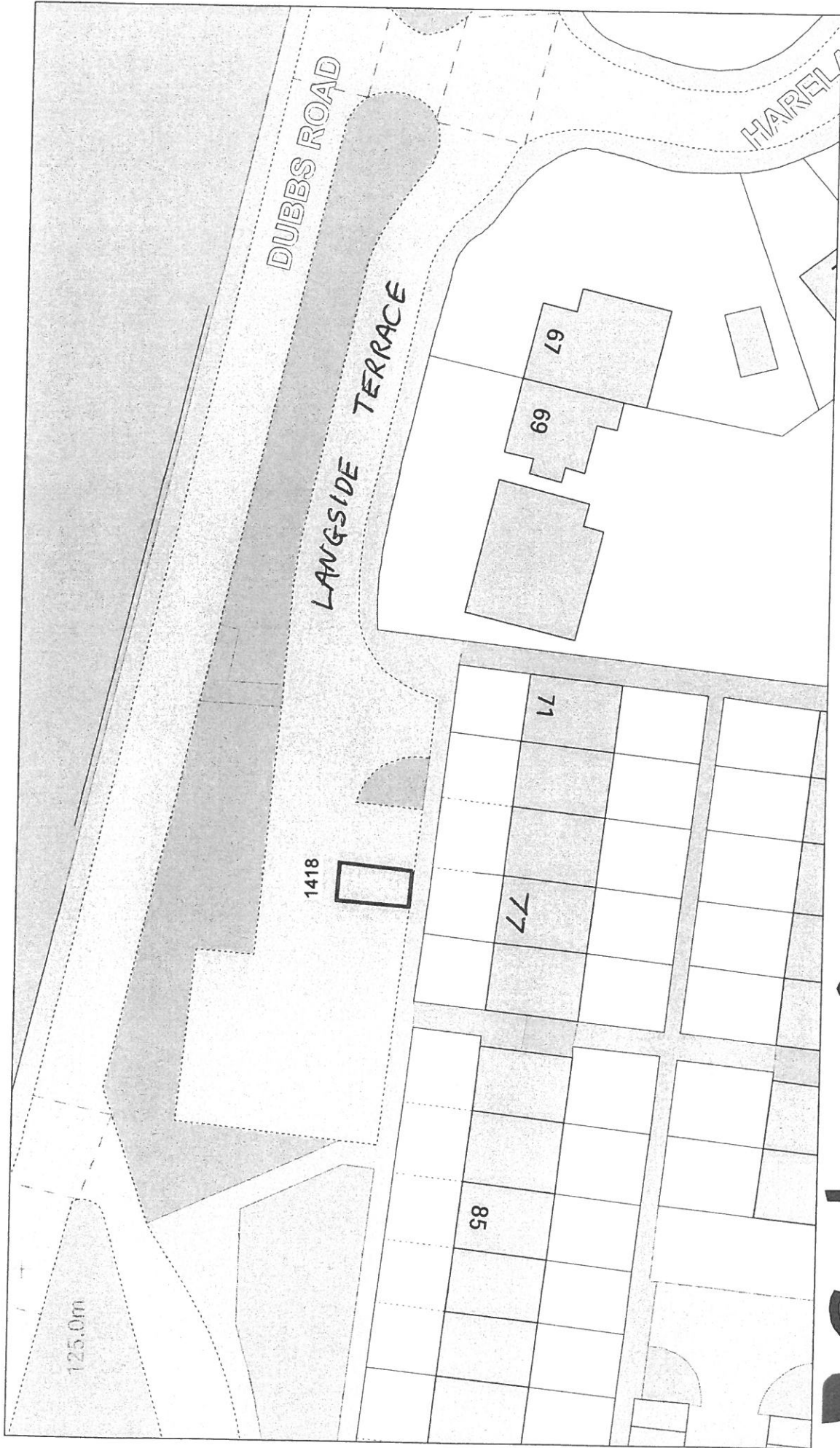

The material has been reproduced from Ordnance Survey digital map data with Her Majesty's Stationery Office. © Crown copyright. Licence Number: 1000000000

DISABLED PERSONS' PARKING PLACE  
 77 LANGSIDE TERRACE, PORT GLASGOW  
 PLACE No. 1418

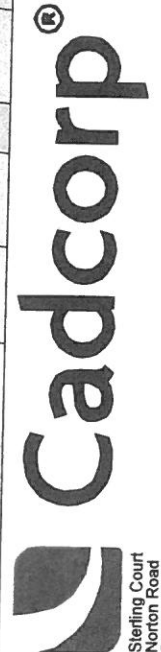

Sterling Court  
 Norton Road  
 Stevenage  
 Herts SG1 2JY  
 UK

Tel : +44 (0)1438 747996  
 Fax : +44 (0)1438 747987  
 E-mail: info@cadcorp.com

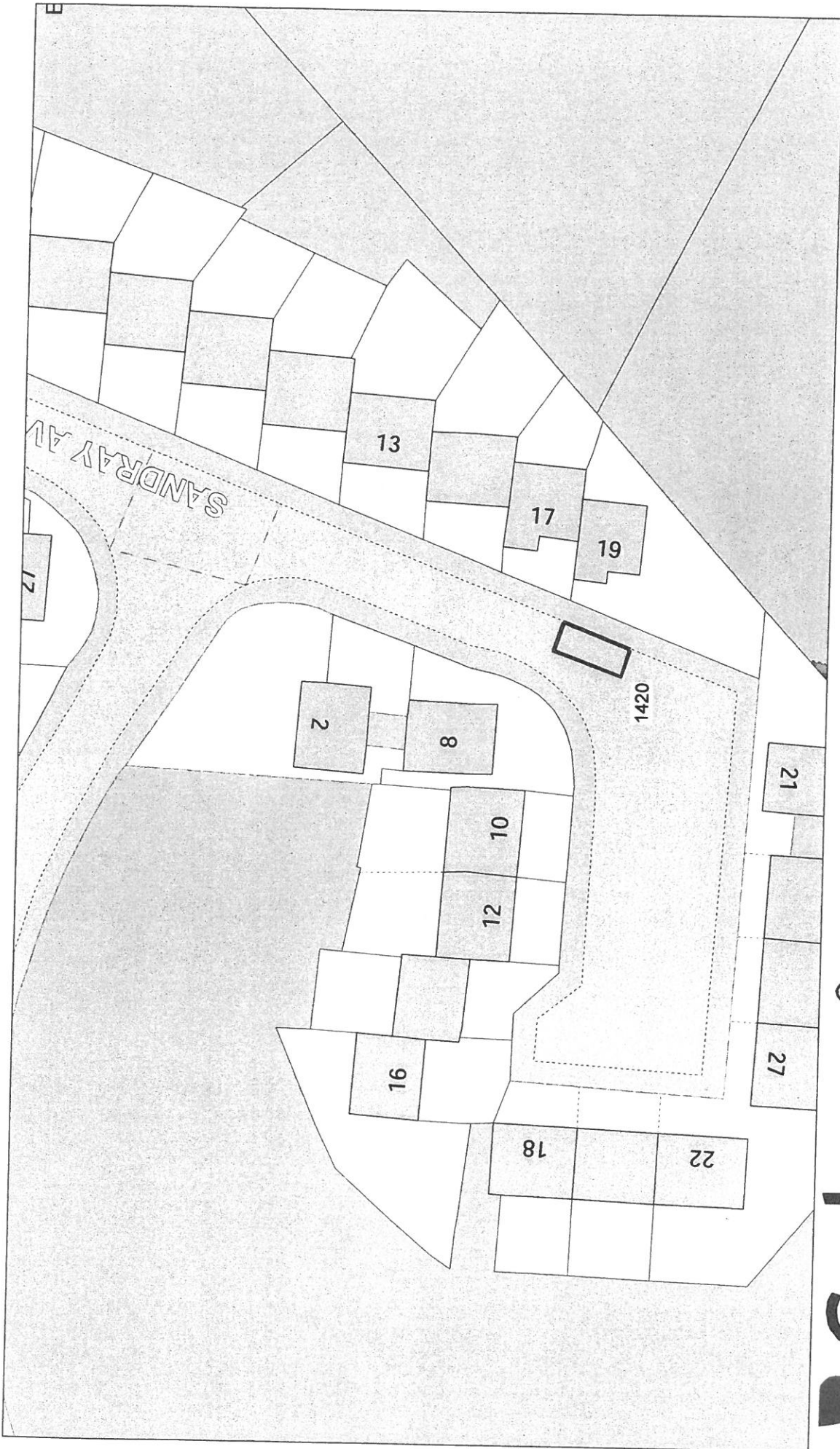

The material has been reproduced from  
 Ordnance Survey digital map data with  
 permission of the Controller of  
 Her Majesty's Stationery Office.  
 © Crown copyright.  
 Licence Number: nnnnnn



Sterling Court  
 Norton Road  
 Stevenage  
 Herts SG1 2JY  
 UK

Tel : +44 (0)1438 747986  
 Fax : +44 (0)1438 747987  
 E-mail: info@cadcorp.com

**DISABLED PERSONS' PARKING PLACE**  
 19 SANDRAY AVENUE, PORT GLASGOW  
 PLACE No. 1420



**OS** Ordnance Survey  
 Licensed System Supplier

The material has been reproduced from  
 Ordnance Survey digital map data with  
 the permission of the Controller of  
 Her Majesty's Stationery Office.  
 © Crown copyright. 100000000  
 Licence Number: 100000000

**Cadcorp®**

Sterling Court  
 Norton Road  
 Stevenage  
 Herts SG1 2JY  
 UK

Tel : +44 (0)1438 747996  
 Fax : +44 (0)1438 747997  
 E-mail: info@cadcorp.com

DISABLED PERSONS' PARKING PLACE  
 16 NORTHFIELD AVENUE, PORT GLASGOW  
 PLACE No. 1422

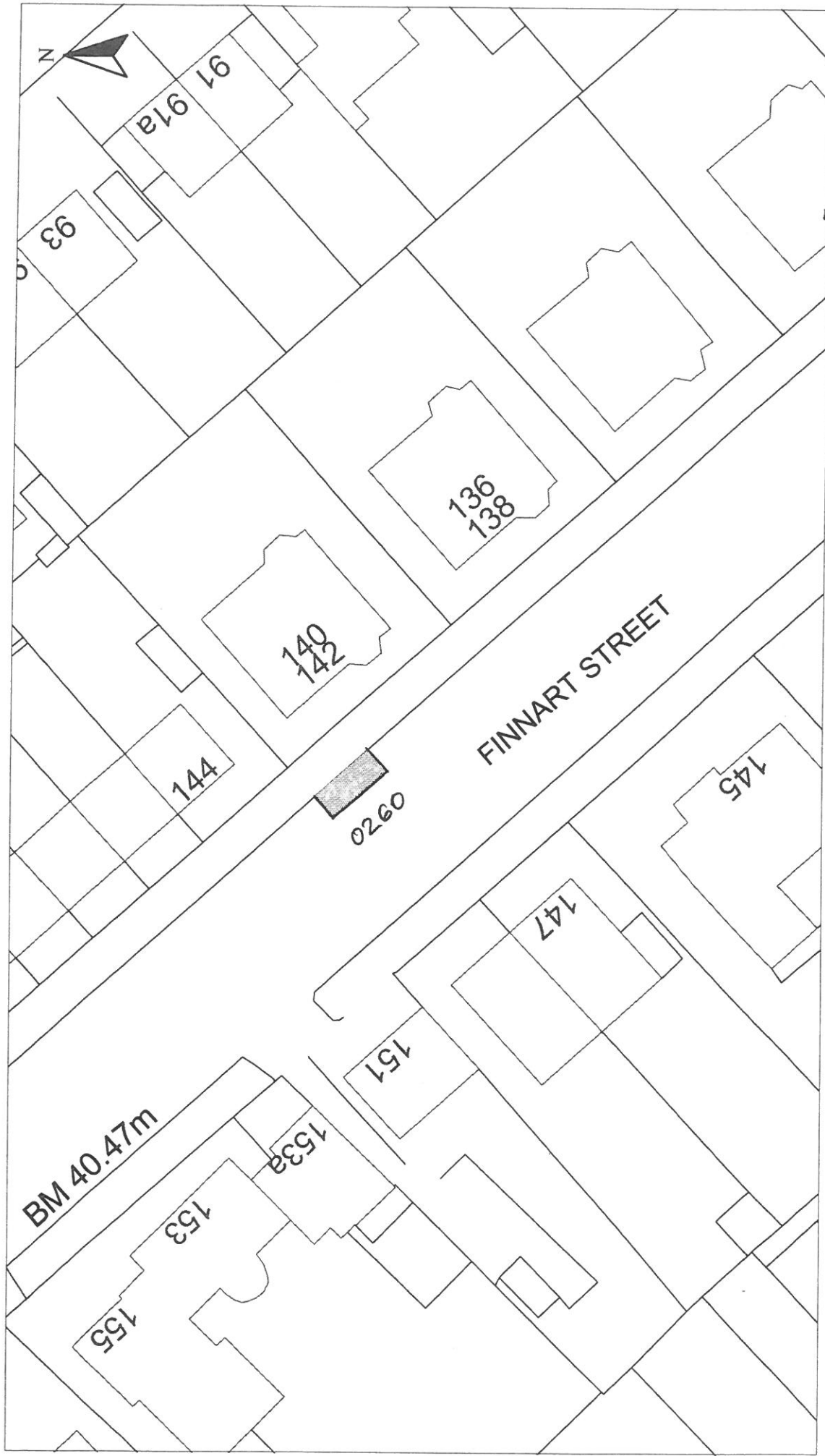

HEAD OF TRANSPORTATION AND ROADS  
R.J. SMALL B.Sc., C.Eng., M.I.C.E.

Disabled Bays  
71 EAST HAMILTON STREET  
GREENOCK, PA15 2UA

Reproduced from Ordnance Survey mapping with the permission of the Controller of Her Majesty's Stationery Office. Crown Copyright.  
Unauthorised reproduction infringes Crown Copyright and may result in prosecution or legal proceedings.  
Licence No. LA03097L

**DISABLED DRIVER'S PARKING BAY**  
**142 FINNART STREET, GREENOCK**  
**PLACE No. 0260 REVOCATION**

Scale :	1:500	Date :	MAY 2003
Prepared by :	R. MACKAY	Checked by :	
Drawn by :	R. MACKAY	Approved by :	
Drawing No. :		File No. :	19/12

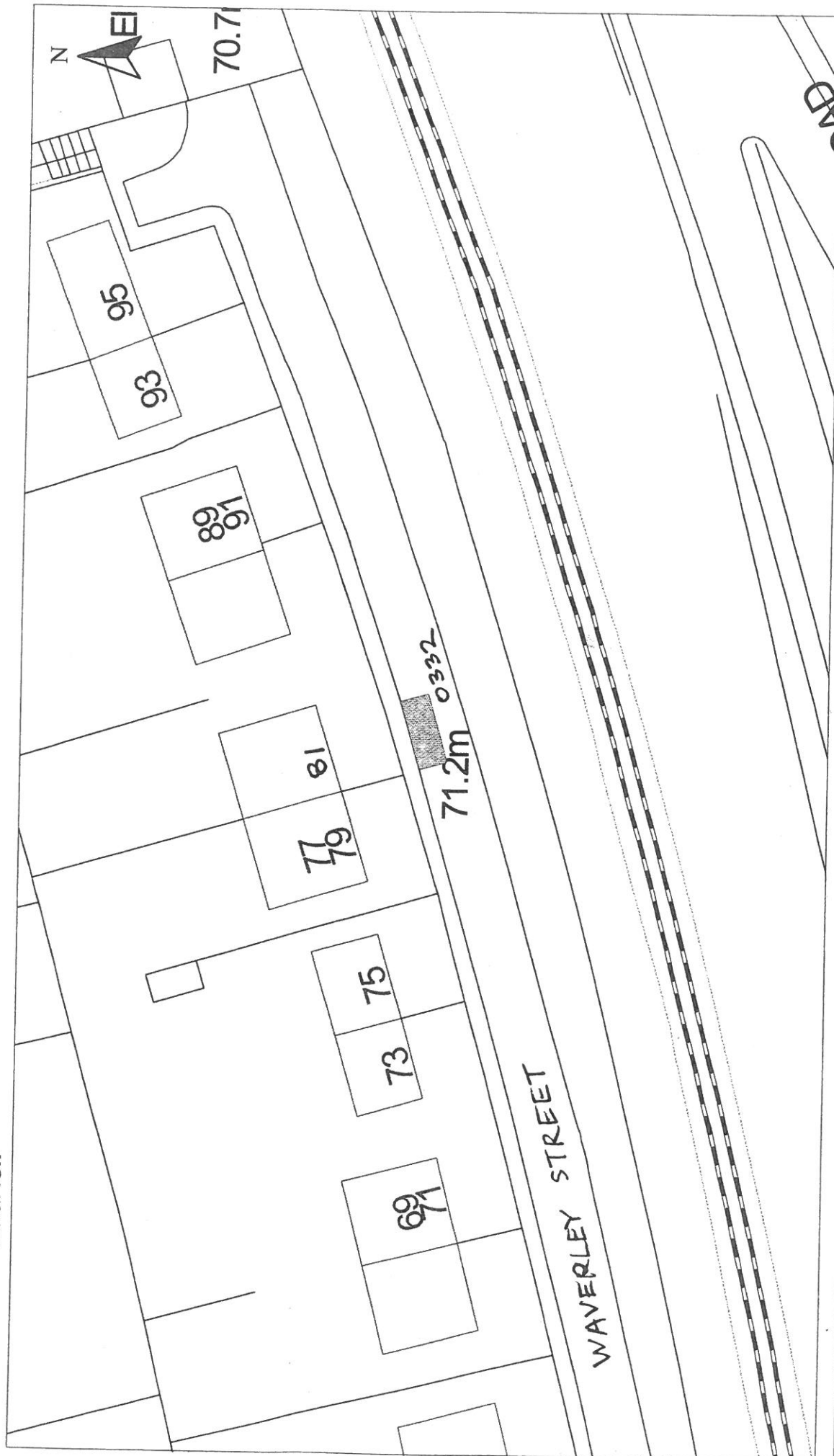

<p>HEAD OF TRANSPORTATION AND ROADS E. McCARRON C.Eng., M.I.C.E.</p>		<p>Scale : 1:500</p>		<p>Date : JULY 2004</p>	
<p>71 EAST HAMILTON STREET GREENOCK, PA15 2UA</p>		<p>Prepared by : R. MACKAY</p>		<p>Checked by :</p>	
<p>Disabled Bays</p>		<p>Drawn by : R. MACKAY</p>		<p>Approved by :</p>	
<p>DISABLED DRIVER'S PARKING BAY 81 WAVERLEY STREET, GREENOCK PLACE No. 0332 REVOCATION</p>		<p>Drawing No. :</p>		<p>File No. : 19/12</p>	
<p><small>Reproduced from Ordnance Survey mapping with the permission of the Controller of Her Majesty's Stationery Office. Crown Copyright. Unauthorised reproduction infringes Crown Copyright and may result in prosecution or legal proceedings. Licence No. LA00097L</small></p>					

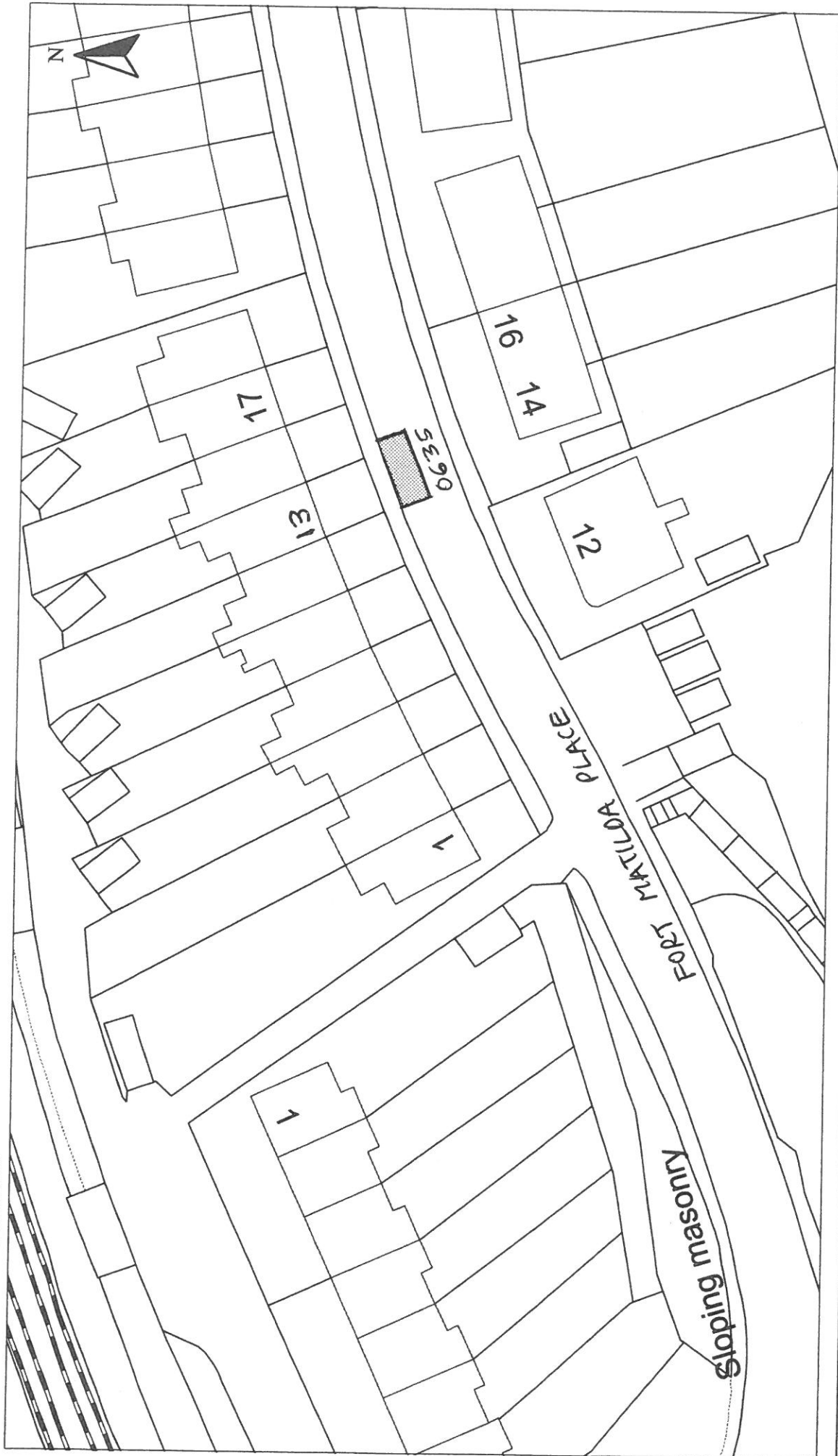

HEAD OF TRANSPORTATION AND ROADS  
R.M. GRAHAM M.C.M.I., A.I.M.B.M.

Disabled Bays  
71 EAST HAMILTON STREET  
GREENOCK, PA15 2UA

Reproduced from Ordnance Survey mapping with the permission of the Controller of Her Majesty's Stationary Office. Crown Copyright. Use in any reproduction infringes Crown Copyright and may result in prosecution or legal proceedings.

Licence No. LA03087L  
**OS** Ordnance Survey

**DISABLED PERSON'S PARKING BAY**  
13 FORT MATILDA PLACE, GOUROCK  
PLACE No. 0635 REVOCATION

Scale : 1:500

Prepared by : R. MACKAY

Drawn by : R. MACKAY

Drawing No. :

Date : OCT 2006

Checked by :

Approved by :

File No. : 19/12



HEAD OF PLANNING, HOUSING AND  
TRANSPORTATION :- F. K. WILLIAMSON

Disabled Bays  
6 CATHCART SQUARE  
GREENOCK, PA15 1LS

Reproduced from Ordnance Survey mapping with the permission  
of the Controller of Her Majesty's Stationary Office. Crown  
Copyright. Unauthorised reproduction infringes Crown Copyright  
and may result in prosecution or legal proceedings.  
Licence No. 1000023421  
(2008)



**DISABLED PERSON'S PARKING BAY**

16 GRENVILLE ROAD, GOUROCK  
PLACE No. 0750 REVOCATION

Scale : 1:500

Prepared by : R. MACKAY

Drawn by : R. MACKAY

Drawing No. :

Date : FEB 2008

Checked by :

Approved by :

File No. : 19/12



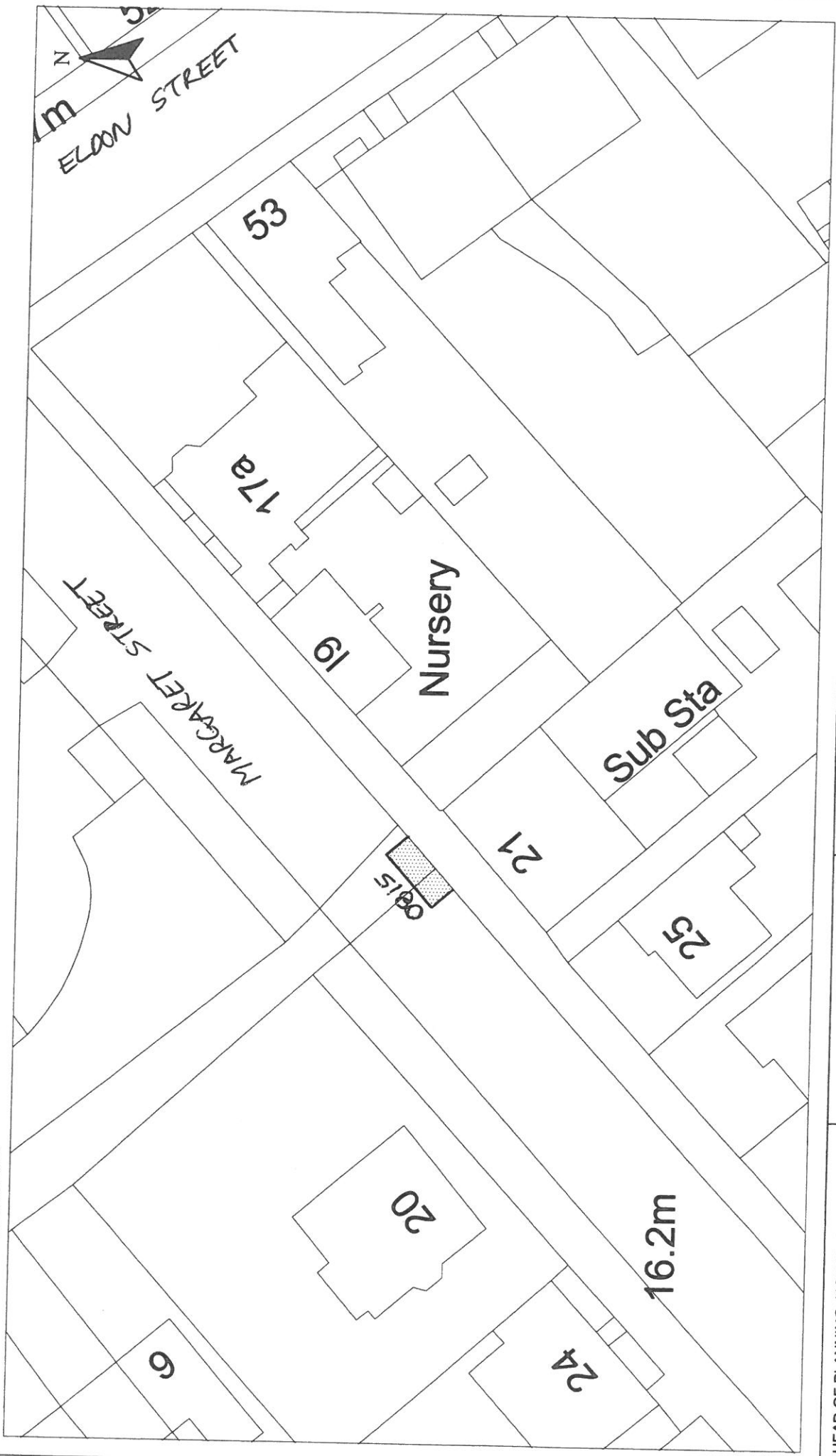

**HEAD OF PLANNING, HOUSING AND TRANSPORTATION :- F. K. WILLIAMSON**

Disabled Bays  
6 CATHCART SQUARE  
GREENOCK, PA15 1LS

Reproduced from Ordnance Survey mapping with the permission of Her Majesty's Stationery Office. Crown Copyright. Use of reproduction infringes Crown Copyright and may result in prosecution or legal proceedings.

Licence No. 1000023421 (2008)

**DISABLED PERSON'S PARKING BAY**  
21 MARGARET STREET, GREENOCK  
PLACE No. 0815 REVOCATION

Scale :	1:500	Date :	MAY 2008
Prepared by :	R. MACKAY	Checked by :	
Drawn by :	R. MACKAY	Approved by :	
Drawing No. :		File No. :	19/12

# Inverclyde council ENVIRONMENTAL SERVICES

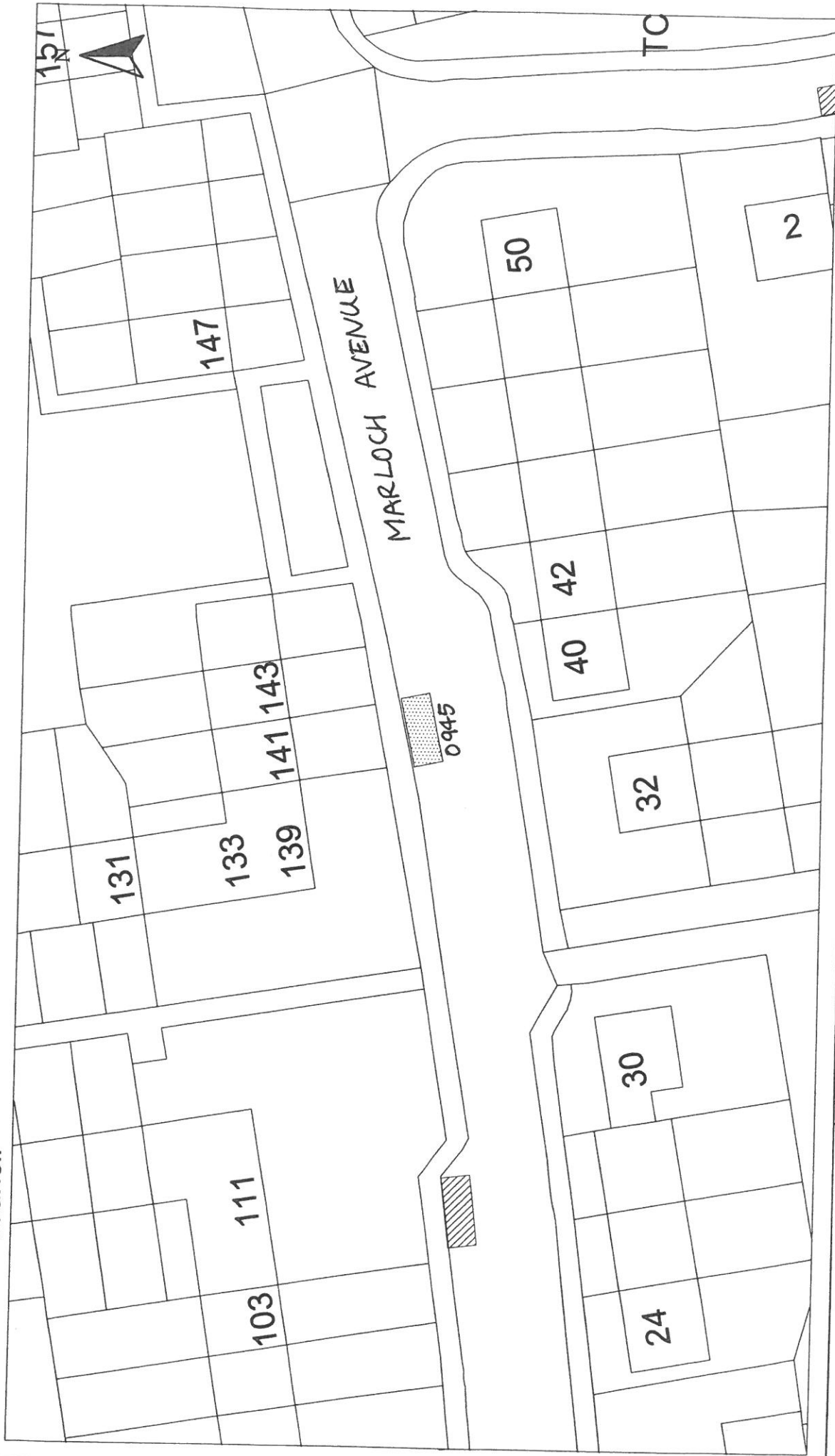

<b>HEAD OF SERVICE</b> ALAN G BARNES MCIWM CEnv		Scale : 1:500 Date : NOV 2009	
Disabled Bays 71 EAST HAMILTON STREET GREENOCK, PA15 2UA		Prepared by : R. MACKAY Checked by : Drawn by : R. MACKAY Approved by : Drawing No. :	
Reproduced from Ordnance Survey mapping with the permission of the Controller of Her Majesty's Stationery Office. Crown Copyright. Unauthorised reproduction infringes Crown Copyright and may result in prosecution or legal proceedings. Licence No. LA03097L 		<b>DISABLED PERSONS' PARKING PLACE</b> 141 MARLOCH AVENUE, PORT GLASGOW PLACE No. 0945 REVOCATION	
		File No. : 19/12	

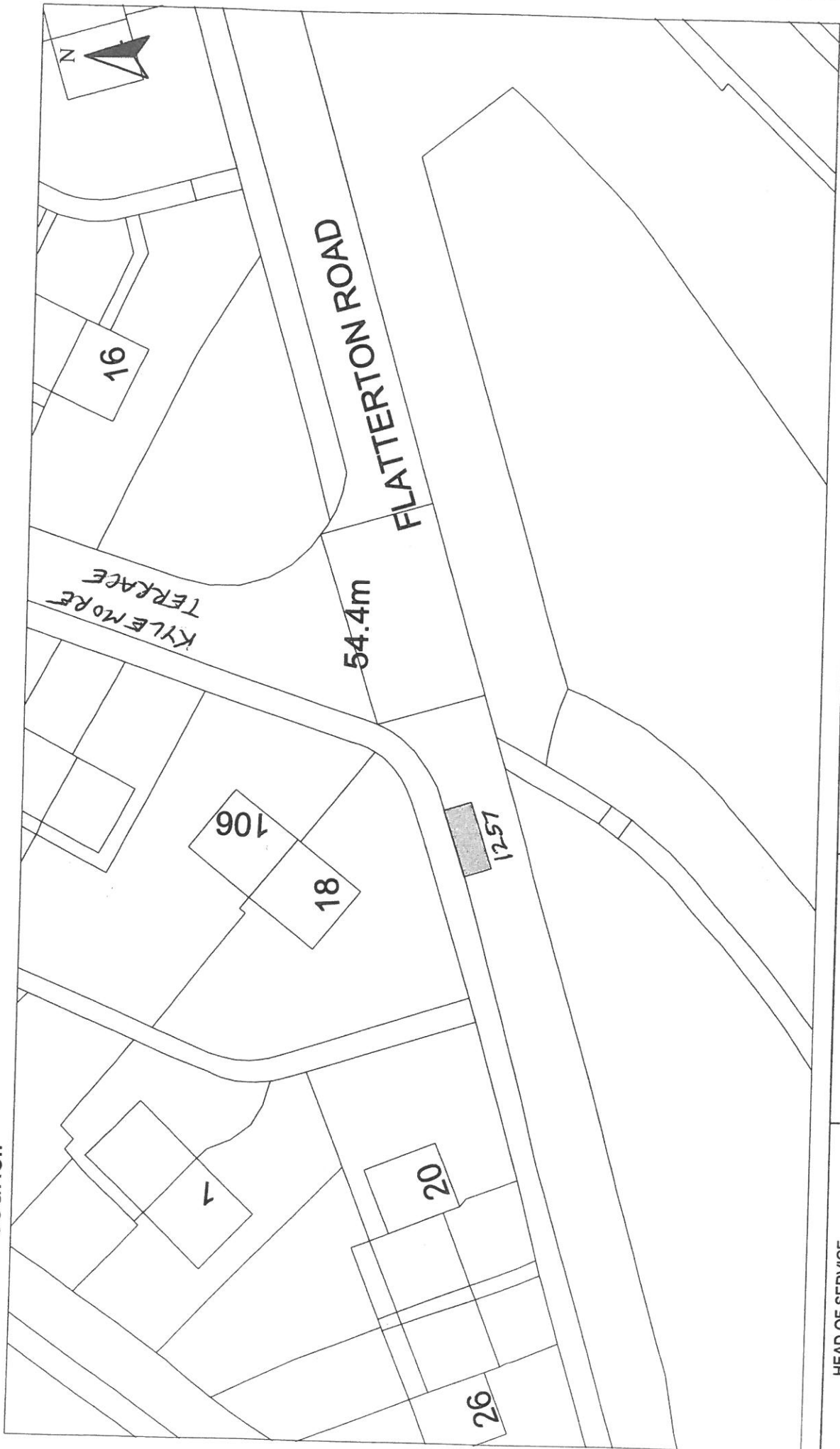

HEAD OF SERVICE  
IAN MOFFAT

71 EAST HAMILTON STREET  
GREENOCK, PA15 2UA

Reproduced from Ordnance Survey mapping with the permission of the Controller Her Majesty's Stationery Office. Crown Copyright. Unauthorised reproduction from infringes Crown Copyright and may result in prosecution or legal proceedings.



**DISABLED PERSONS' PARKING PLACE**

18 FLATTERTON ROAD, GREENOCK

PLACE No. 1257 REVOCATION

Scale : 1:500

Prepared by : R. MACKAY

Drawn by : R. MACKAY

Date : JAN 2013

Checked by :

Approved by :

File No. : 19/12

**Inverclyde** ENVIRONMENTAL & COMMERCIAL SERVICES  
council



HEAD OF SERVICE IAN MOFFAT		Scale : 1:500		Date : JULY 2013	
71 EAST HAMILTON STREET GREENOCK, PA15 2UA		Prepared by : R. MACKAY		Checked by :	
Disabled Bays		Drawn by : R. MACKAY		Approved by :	
Reproduced from Ordnance Survey mapping with the permission of the Controller of Her Majesty's Stationery Office. Copyright. Unauthorised reproduction infringes Crown Copyright and may result in prosecution or legal proceedings.		Disabled PERSONS' PARKING PLACE		Drawing No. : 19/12	
Licence No. LA03097L 		57 BRIDGEND AVENUE, PORT GLASGOW PLACE No. 1333 REVOCATION			

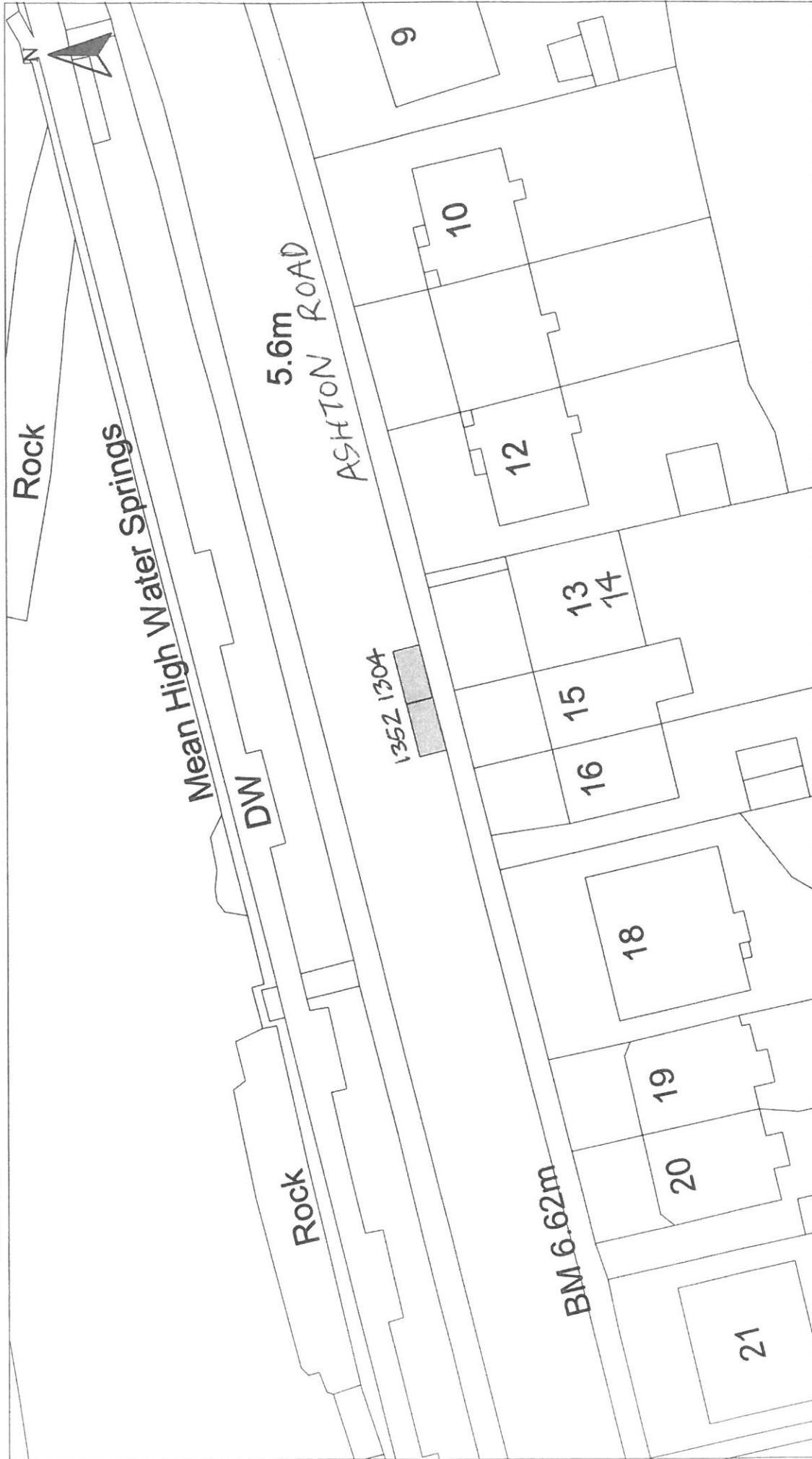

<p>HEAD OF SERVICE IAN MOFFAT</p>		<p>Scale : 1:500</p>		<p>Date : NOV 2013</p>	
<p>71 EAST HAMILTON STREET GREENOCK, PA15 2UA</p>		<p>Prepared by : R. MACKAY</p>		<p>Checked by :</p>	
<p>Disabled Bays</p>		<p>Drawn by : R. MACKAY</p>		<p>Approved by :</p>	
<p>DISABLED PERSONS' PARKING PLACE 14 &amp; 15 ASHTON ROAD, GOUROCK PLACES Nos. 1304 &amp; 1352 REVOCATION</p>		<p>Drawing No. :</p>		<p>File No. : 19/12</p>	
<p><small>Reproduced from Ordnance Survey mapping with the permission of the Controller of Her Majesty's Stationary Office. Crown Copyright. Unauthorised reproduction infringes Crown Copyright and may result in prosecution or legal proceedings.</small></p>					
<p><small>Licence No. LA03097L</small></p>					
<p><b>Ordnance Survey</b></p>					



HEAD OF SERVICE IAN MOFFAT	Reproduced from Ordnance Survey mapping with the permission of the Controller of Her Majesty's Stationery Office. Crown Copyright. Unauthorised reproduction infringes Crown Copyright and may result in prosecution or legal proceedings.	<b>DISABLED PERSONS' PARKING PLACE</b> 28 BRAESIDE ROAD, GREENOCK PLACE No. 1343 REVOCATION	Scale : 1:500 Prepared by : R. MACKAY Drawn by : R. MACKAY	Date : NOV 2013 Checked by : Approved by :
Disabled Bays 71 EAST HAMILTON STREET GREENOCK, PA15 2UA	Licence No. LA03097L 		Drawing No. :	File No. : 40140